

WARMING TRENDS®

SUPERIOR FIRE FEATURE SYSTEMS

Please note:

We have introduced two new Flex Line Kits and are discontinuing several SKUs. This will take effect January 18th, 2021.

[Click here](#) for the full Product Bulletin regarding these changes.

These changes are included in this catalog.

PATENTED

www.warming-trends.com/patents

WARMING TRENDS®

Superior Design. Superior Performance.
Superior Fire Feature Systems.



Standard Ring Burner with 180K BTU's

Don't settle for less.



CFB180 CROSSFIRE® Brass Burner with
180k BTU's

The patented CROSSFIRE® Brass Burner is the most fuel efficient burner in the industry,
producing beautiful, tall, bright flames all while consuming less gas.

100% Brass. Lifetime Warranty. Made in the United States.

SIX STEPS TO FIRE!

- 1 Measure the interior dimension of your fire pit.
- 2 Choose the corresponding Plate or Pan size. (Pans include a 2" welded sidewall).
- 3 Select Burner based on appropriate size and Fuel Type. (Natural Gas or Liquid Propane).
- 4 Choose the Ignition System: match lit, push button, or on/off switch.
- 5 Add Optional Electronic Accessories: remote control options, dial timers, and emergency stop buttons.
- 6 Complete the fire pit with Accessories: steel or ceramic logs, lava rock, or fire glass.

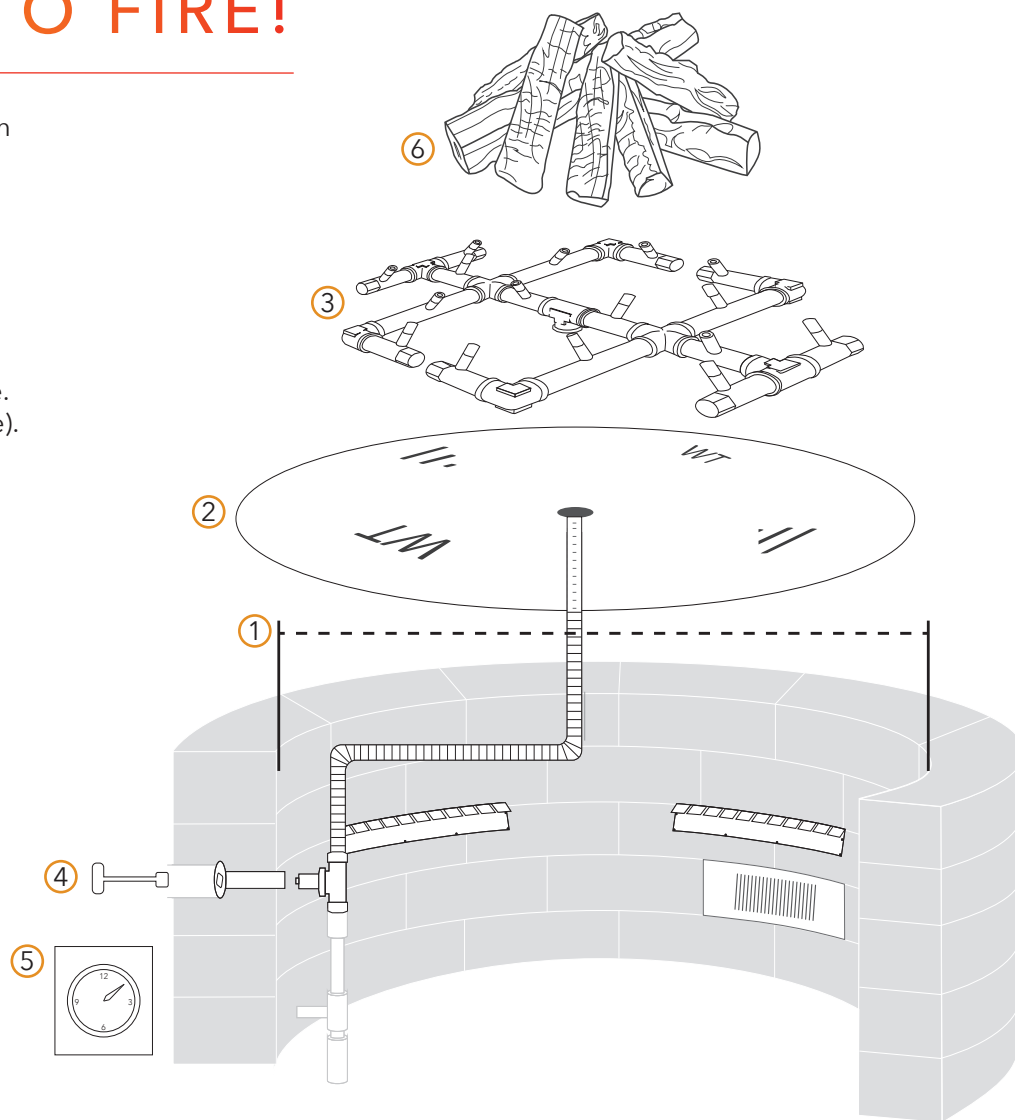

BURNER MATCH FOR COMMON INTERIOR DIMENSIONS

Choose a burner based on the inside dimension of your enclosure - the fire pit plate or pan should be 6" larger than the burner to provide at least 3" between the edge of the burner and the inside edge of the fire feature.

INTERIOR DIMENSION	CIRCLE	SQUARE
24"	CFB120	CFB120
	CFBO180	CFBO180
30"	CFB180	CFB180
	CFB240	CFB240
	CFBO280	CFBO280
36"	CFB240	CFB240
	CFB290	CFB290
	CFBO280	CFBO280
42"	CFBO360	CFBO360

TABLE OF CONTENTS

Options for Circular Openings	6
Options for Square Openings	14
Options for Rectangular Openings	21
Plates and Pans	30
Ready-to-Finish Kits	33
Universal Paver Kits	38
Ignitions, Accessories, & Media	42
Warranty	47

877 556 5255

orders@warming-trends.com

www.Warming-Trends.com





OPTIONS FOR CIRCULAR OPENINGS

Designed for standard circular fire features, these CROSSFIRE® Brass Burners range from 60K to 450K BTUs.

Need a different size or shape? We're happy to help. Call our Flame Consultants at 877 556 5255



ORIGINAL CFB60

For 18" opening or larger

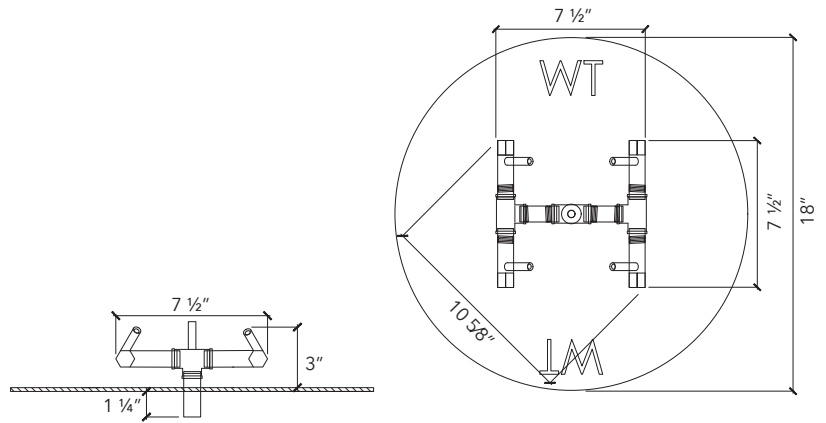

SKU (NG OR LP)	DESCRIPTION	SHIP WEIGHT	SHIP DIMENSIONS
CFB60NG CFB60LP	60K BTU Original Brass Burner	4 lbs	11" x 11" x 5"
Recommended parts: Plate: ALPL18C (circle) • 3/4" Flex Line Kit • Optional 3x Support Collars			
CFB60NGALPL18C CFB60LPALPL18C	with 18" Circular Plate	9 lbs	19" x 19" x 7"
CFB60NGALPL18CFK1 CFB60LPALPL18CFK1	with 18" Circular Plate + 3/4" Flex Line Kit	12 lbs	19" x 19" x 7"
Compatible Ignition Systems: Push Button, 3 Volt, 24 Volt Spark Ignition, 24 Volt Hot Surface Ignition (SC)			

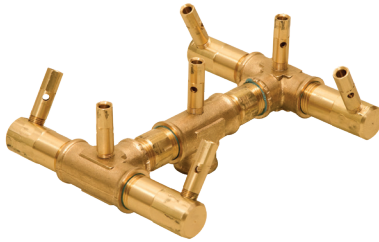

ORIGINAL CFB84

For 18" opening or larger

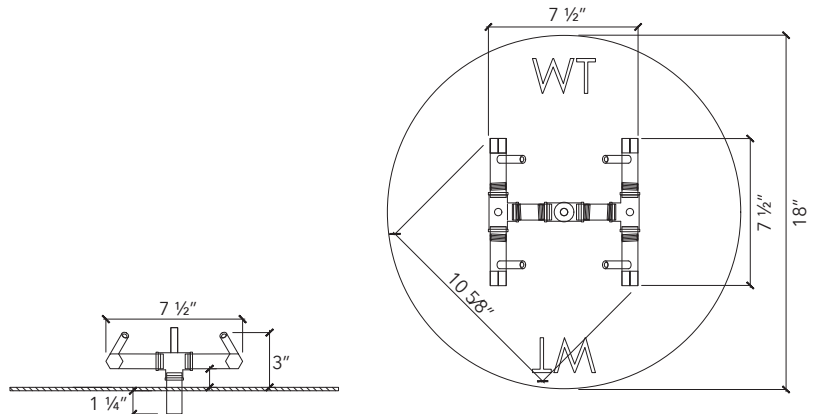

SKU (NG OR LP)	DESCRIPTION	SHIP WEIGHT	SHIP DIMENSIONS
CFB84NG CFB84LP	84K BTU Original Brass Burner	4 lbs	11" x 11" x 5"
Recommended parts: Plate: ALPL18C (circle) • 3/4" Flex Line Kit • Optional 3x Support Collars			
CFB84NGALPL18C CFB84LPALPL18C	with 18" Circular Plate	9 lbs	19" x 19" x 7"
CFB84NGALPL18CFK1 CFB84LPALPL18CFK1	with 18" Circular Plate + 3/4" Flex Line Kit	12 lbs	19" x 19" x 7"
Compatible Ignition Systems: Push Button, 3 Volt, 24 Volt Spark Ignition, 24 Volt Hot Surface Ignition (SC)			

SKU BREAKDOWN	Octagonal (Burner Type)		Gas Type		Size of Plate		Flex Line Kit	
	CROSSFIRE Brass Burner	BTU	Plate or Pan	Shape of Plate				
	CFB	O	360	NG	ALPL	42	CF	FK2



ORIGINAL CFB120

For 24" opening or larger

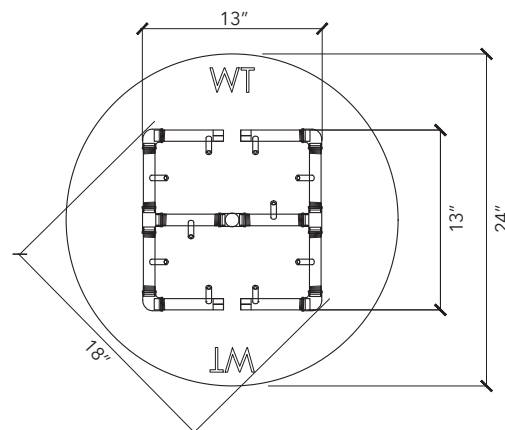
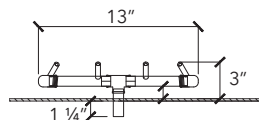

SKU (NG OR LP)	DESCRIPTION	SHIP WEIGHT	SHIP DIMENSIONS
CFB120NG CFB120LP	120K BTU Original Brass Burner	8 lbs	15" x 15" x 5"
Recommended parts: Plate: ALPL24C (circle) • 3/4" Flex Line Kit • Optional 4x Support Collars			
CFB120NGALPL24C CFB120LPALPL24C	with 24" Circular Plate	13 lbs	25" x 25" x 7"
CFB120NGALPL24CFK1 CFB120LPALPL24CFK1	with 24" Circular Plate + 3/4" Flex Line Kit	16 lbs	25" x 25" x 7"
Compatible Ignition Systems: Push Button, 3 Volt, 24 Volt Spark Ignition, 24 Volt Hot Surface Ignition (SC)			

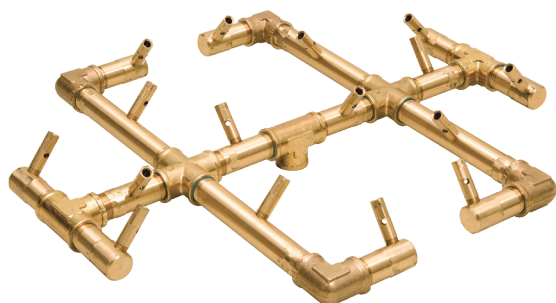

ORIGINAL CFB180

For 30" opening or larger

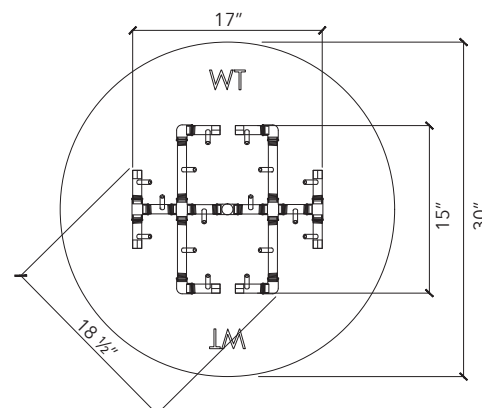
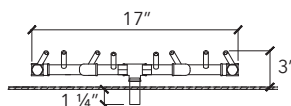

SKU (NG OR LP)	DESCRIPTION	SHIP WEIGHT	SHIP DIMENSIONS
CFB180NG CFB180LP	180K BTU Original Brass Burner	9 lbs	19" x 19" x 7"
Recommended parts: Plate: ALPL30C (circle) • 3/4" Flex Line Kit • Optional 5x Support Collars			
CFB180NGALPL30C CFB180LPALPL30C	with 30" Circular Plate	17 lbs	31" x 31" x 7"
CFB180NGALPL30CFK1 CFB180LPALPL30CFK1	with 30" Circular Plate + 3/4" Flex Line Kit	20 lbs	31" x 31" x 7"
Compatible Ignition Systems: Push Button, 24 Volt Spark Ignition, 24 Volt Hot Surface Ignition (SC)			

PAN AND PLATES AVAILABLE ON PAGE 30



ORIGINAL CFB240

For 30" opening or larger

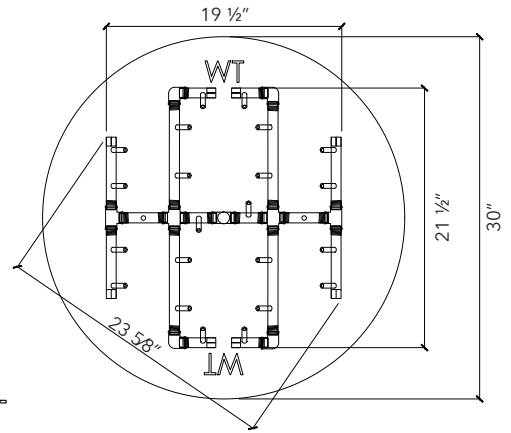
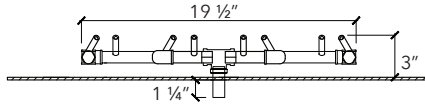

SKU (NG OR LP)	DESCRIPTION	SHIP WEIGHT	SHIP DIMENSIONS
CFB240NG CFB240LP	240K BTU Original Brass Burner	12 lbs	23" x 23" x 7"
Recommended parts: Plate: ALPL30C (circle) • 3/4" Flex Line Kit • Optional 5x Support Collars			
CFB240NGALPL30C CFB240LPALPL30C	with 30" Circular Plate	20 lbs	31" x 31" x 7"
CFB240NGALPL30CFK1 CFB240LPALPL30CFK1	with 30" Circular Plate + 3/4" Flex Line Kit	23 lbs	31" x 31" x 7"
Compatible Ignition Systems: Push Button, 24 Volt Spark Ignition, 24 Volt Hot Surface Ignition (SC)			

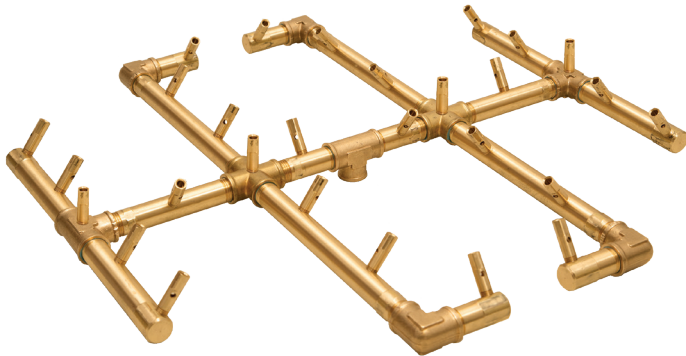

ORIGINAL CFB290

For 36" opening or larger

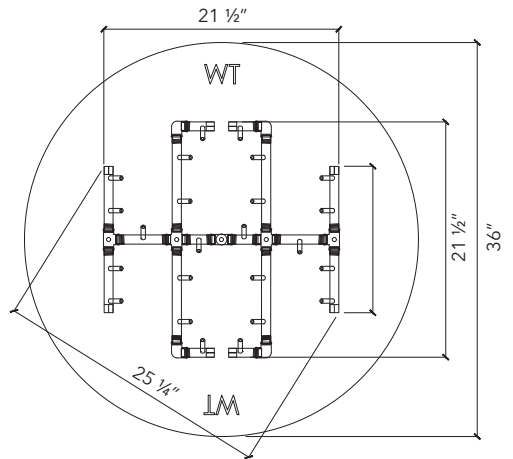
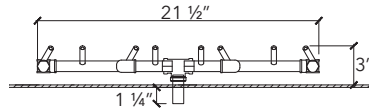

SKU (NG OR LP)	DESCRIPTION	SHIP WEIGHT	SHIP DIMENSIONS
CFB290NG CFB290LP	290K BTU Original Brass Burner	12 lbs	23" x 23" x 7"
Recommended parts: Plate: ALPL18C (circle) • 3/4" Dual Flex Line Kit • Optional 6x Support Collars			
CFB290NGALPL36C CFB290LPALPL36C	with 36" Circular Plate	24 lbs	37" x 37" x 9"
CFB290NGALPL36CFK2 CFB290LPALPL36CFK2	with 36" Circular Plate + 3/4" Dual Flex Line Kit	27 lbs	37" x 37" x 9"
Compatible Ignition Systems: Push Button, 24 Volt Spark Ignition, 24 Volt Hot Surface Ignition (SC)			

SKU BREAKDOWN

C	F	B	O	3	6	0	N	G	A	L	P	L	4	2	C	F	K	2
CROSSFIRE Brass Burner			BTU			Plate or Pan			Shape of Plate			Flex Line Kit						

Octagonal (Burner Type) Gas Type Size of Plate

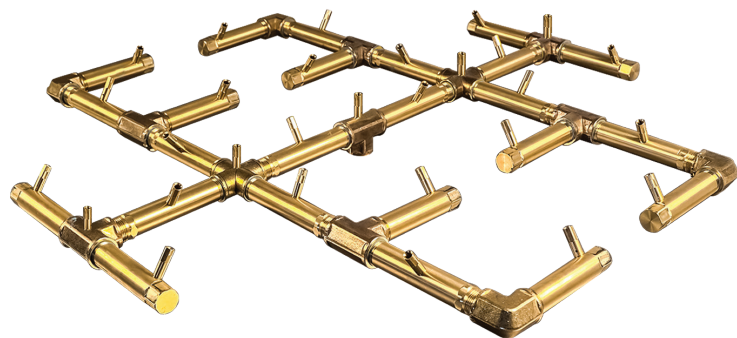

ORIGINAL CFB350

For 48" opening or larger

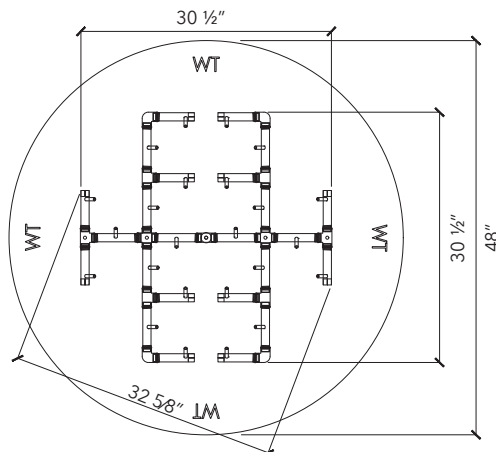
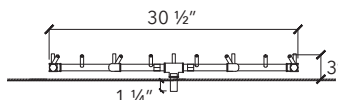

SKU (NG OR LP)	DESCRIPTION	SHIP WEIGHT	SHIP DIMENSIONS
CFB350NG CFB350LP	350K BTU Original Brass Burner	23 lbs	33" x 33" x 9"
Recommended parts: Plate: ALPL48C (circle) • ¾" Dual Flex Line Kit • Optional 8x Support Collars			
CFB350NGALPL48C CFB350LPALPL48C	with 48" Circular Plate	SHIPS FREIGHT	
CFB350NGALPL48CFK2 CFB350LPALPL48CFK2	with 48" Circular Plate + ¾" Dual Flex Line Kit	SHIPS FREIGHT	
Compatible Ignition Systems: 24 Volt Spark Ignition, 24 Volt Hot Surface Ignition (HC)			



ORIGINAL CFB450

For 60" opening or larger

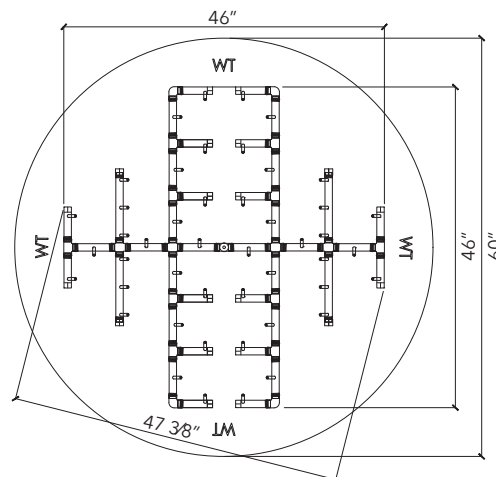
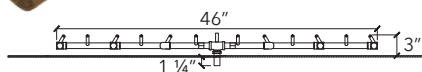

SKU (NG OR LP)	DESCRIPTION	SHIP WEIGHT	SHIP DIMENSIONS
CFB450NG CFB450LP	450K BTU Original Brass Burner	SHIPS FREIGHT	
Recommended parts: Plate: ALPL60C (circle) • ¾" Dual Flex Line Kit • Optional 10x Support Collars			
CFB450NGALPL60C CFB450LPALPL60C	with 60" Circular Plate	SHIPS FREIGHT	
CFB450NGALPL60CFK2 CFB450LPALPL60CFK2	with 60" Circular Plate + ¾" Dual Flex Line Kit	SHIPS FREIGHT	
Compatible Ignition Systems: 24 Volt Spark Ignition, 24 Volt Hot Surface Ignition (HC)			

LIGHT IT UP! IGNITION SYSTEMS START ON PAGE 43



OCTAGONAL CFBO140

For 18" opening or larger

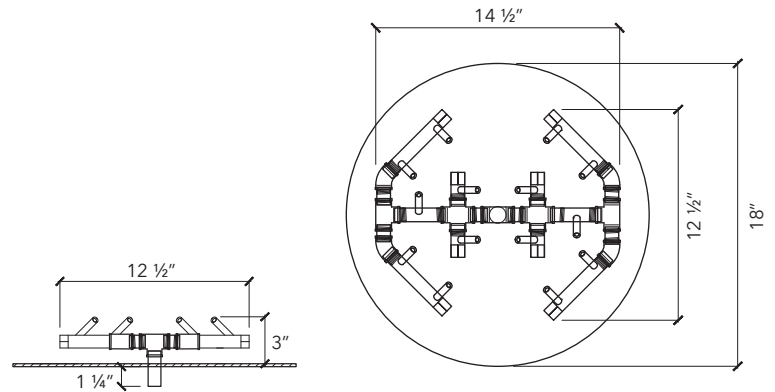

SKU (NG OR LP)	DESCRIPTION	SHIP WEIGHT	SHIP DIMENSIONS
CFBO140NG CFBO140LP	140K BTU Octagonal Brass Burner	9 lbs	19" x 15" x 5"
Recommended parts: Plate: ALPL18C (circle) • 3/4" Flex Line Kit • Optional 3x Support Collars			
CFBO140NGALPL18C CFBO140LPALPL18C	with 18" Circular Plate	13 lbs	19" x 19" x 7"
CFBO140NGALPL18CFK1 CFBO140LPALPL18CFK1	with 18" Circular Plate + 3/4" Flex Line Kit	17 lbs	19" x 19" x 7"
Compatible Ignition Systems: Push Button, 24 Volt Spark Ignition, 24 Volt Hot Surface Ignition (SC)			

Images for reference only. Drawings provided within 1" of variance of burner measurements.

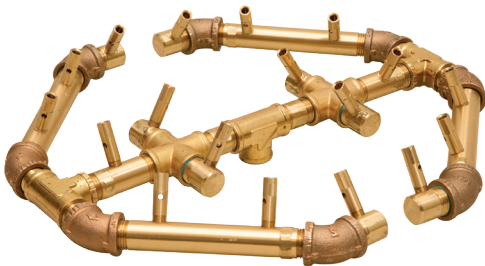

OCTAGONAL CFBO180

For 24" opening or larger

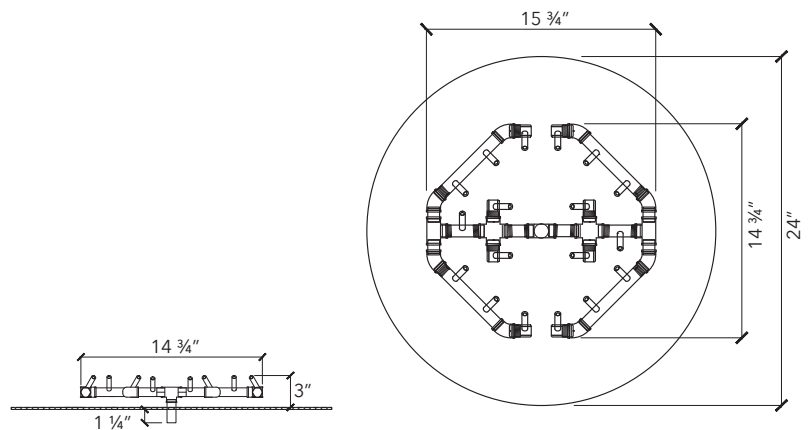

SKU (NG OR LP)	DESCRIPTION	SHIP WEIGHT	SHIP DIMENSIONS
CFBO180NG CFBO180LP	180K BTU Octagonal Brass Burner	10 lbs	19" x 15" x 5"
Recommended parts: Plate: ALPL24C (circle) • 3/4" Flex Line Kit • Optional 4x Support Collars			
CFBO180NGALPL24C CFBO180LPALPL24C	with 24" Circular Plate	15 lbs	25" x 25" x 7"
CFBO180NGALPL24CFK1 CFBO180LPALPL24CFK1	with 24" Circular Plate + 3/4" Flex Line Kit	18 lbs	25" x 25" x 7"
Compatible Ignition Systems: Push Button, 24 Volt Spark Ignition, 24 Volt Hot Surface Ignition (SC)			

Images for reference only. Drawings provided within 1" of variance of burner measurements.

SKU BREAKDOWN																		
C	F	B	O	3	6	0	N	G	A	L	P	L	4	2	C	F	K	2
CROSSFIRE Brass Burner			BTU				Plate or Pan			Shape of Plate								

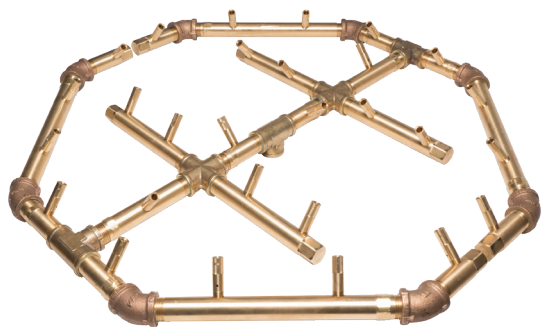

OCTAGONAL CFBO280

For 30" opening or larger

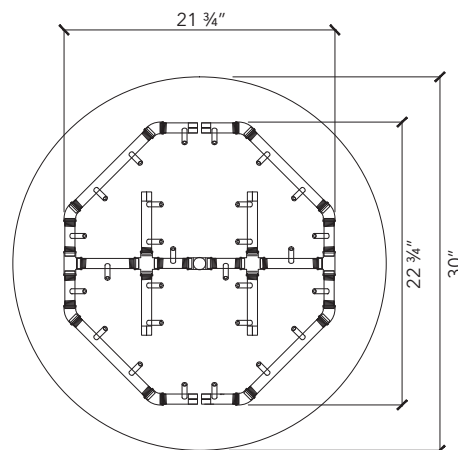
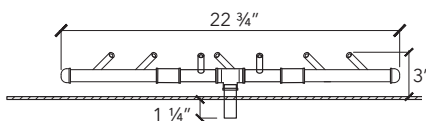

SKU (NG OR LP)	DESCRIPTION	SHIP WEIGHT	SHIP DIMENSIONS
CFBO280NG CFBO280LP	280K BTU Octagonal Brass Burner	13 lbs	25" x 25" x 7"
Recommended parts: Plate: ALPL30C (circle) • 3/4" Dual Flex Line Kit • Optional 5x Support Collars			
CFBO280NGALPL30C CFBO280LPALPL30C	with 30" Circular Plate	21 lbs	31" x 31" x 7"
CFBO280NGALPL30CFK2 CFBO280LPALPL30CFK2	with 30" Circular Plate + 3/4" Dual Flex Line Kit	24 lbs	31" x 31" x 7"
Compatible Ignition Systems: Push Button, 24 Volt Spark Ignition, 24 Volt Hot Surface Ignition (HC)			

Images for reference only. Drawings provided within 1" of variance of burner measurements.

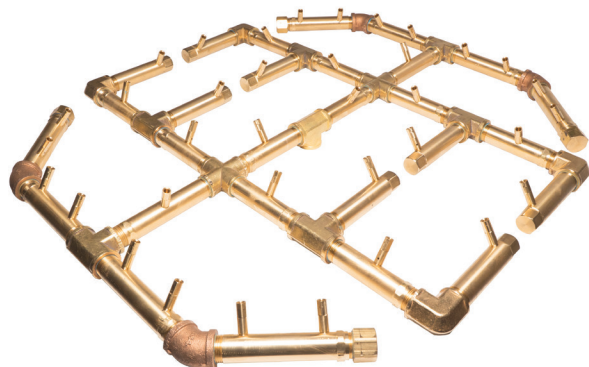

OCTAGONAL CFBO360

For 42" opening or larger

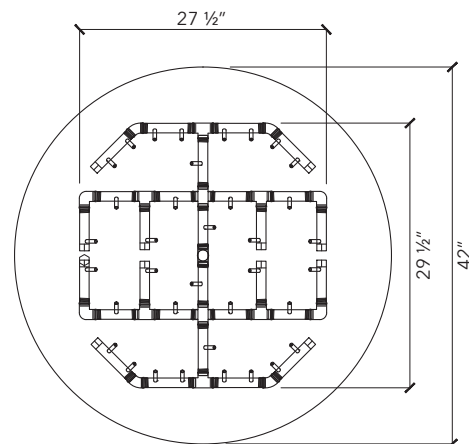
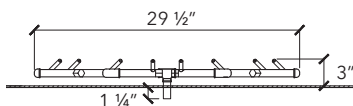

SKU (NG OR LP)	DESCRIPTION	SHIP WEIGHT	SHIP DIMENSIONS
CFBO360NG CFBO360LP	360K BTU Octagonal Brass Burner	22 lbs	31" x 31" x 7"
Recommended parts: Plate: ALPL42C (circle) • ¾" Dual Flex Line Kit • Optional 7x Support Collars			
CFBO360NGALPL42C CFBO360LPALPL42C	with 42" Circular Plate	SHIPS FREIGHT	
CFBO360NGALPL42CFK2 CFBO360LPALPL42CFK2	with 42" Circular Plate + ¾" Dual Flex Line Kit	SHIPS FREIGHT	
Compatible Ignition Systems: 24 Volt Spark Ignition, 24 Volt Hot Surface Ignition (HC)			

Images for reference only. Drawings provided within 1" of variance of burner measurements.

COMPLETE THE FEATURE WITH MEDIA, PAGE 45

Looking for something unique?
In addition to standard products,
Warming Trends® works with customers
every day to design and manufacture
truly custom fire features.
What can we design for you?

Call us today. We'd love to help. 877 556 5255

WARMING  **TRENDS**

Photo credit: Homestyle Landscaping

OPTIONS FOR SQUARE OPENINGS

Designed for square fire features, these CROSSFIRE® Brass Burners range from 60K to 450K BTUs.

Need a different size or shape?
We're happy to help. Call our Flame
Consultants at 877 556 5255





ORIGINAL CFB60

For 18" opening or larger

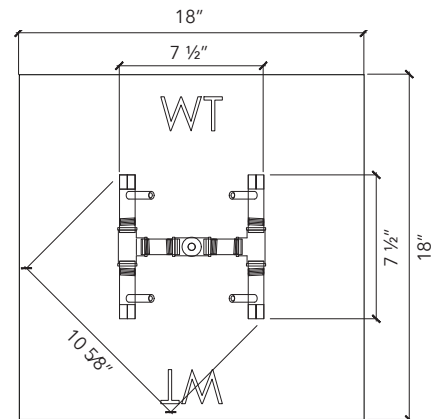
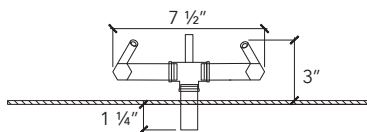

SKU (NG OR LP)	DESCRIPTION	SHIP WEIGHT	SHIP DIMENSIONS
CFB60NG CFB60LP	60K BTU Original Brass Burner	4 lbs	11" x 11" x 5"
Recommended parts: Plate: ALPL18S (square) • 3/4" Flex Line Kit • Optional 3x Support Collars			
CFB60NGALPL18S CFB60LPALPL18S	with 18" Square Plate	8 lbs	20" x 20" x 6"
CFB60NGALPL18SFK1 CFB60LPALPL18SFK1	with 18" Square Plate + 3/4" Flex Line Kit	11 lbs	20" x 20" x 6"
Compatible Ignition Systems: Push Button, 3 Volt, 24 Volt Spark Ignition, 24 Volt Hot Surface Ignition (SC)			



ORIGINAL CFB84

For 18" opening or larger

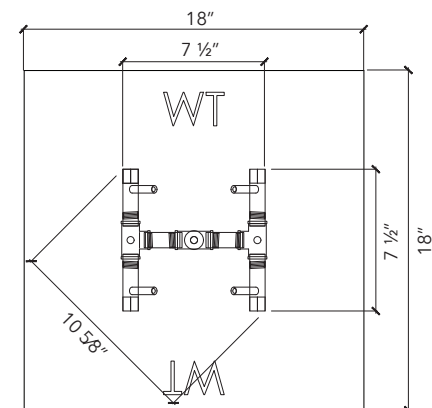
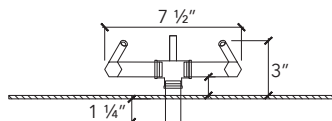

SKU (NG OR LP)	DESCRIPTION	SHIP WEIGHT	SHIP DIMENSIONS
CFB84NG CFB84LP	84K BTU Original Brass Burner	4 lbs	11" x 11" x 5"
Recommended parts: Plate: ALPL18S (square) • 3/4" Flex Line Kit • Optional 3x Support Collars			
CFB84NGALPL18S CFB84LPALPL18S	with 18" Square Plate	8 lbs	21" x 21" x 7"
CFB84NGALPL18SFK1 CFB84LPALPL18SFK1	with 18" Square Plate + 3/4" Flex Line Kit	11 lbs	21" x 21" x 7"
Compatible Ignition Systems: Push Button, 3 Volt, 24 Volt Spark Ignition, 24 Volt Hot Surface Ignition (SC)			

SKU BREAKDOWN	Octagonal (Burner Type)		Gas Type		Size of Plate		Flex Line Kit											
	C	F	B	O	3	6	N	G	A	L	P	L	4	2	C	F	K	2
	CROSSFIRE Brass Burner		BTU		Plate or Pan		Shape of Plate											

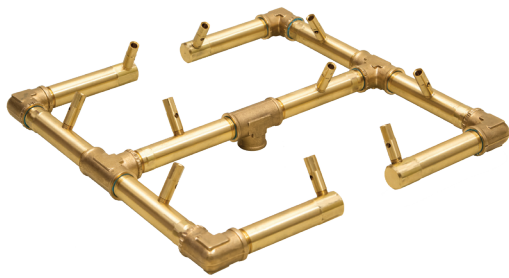

ORIGINAL CFB120

For 24" opening or larger

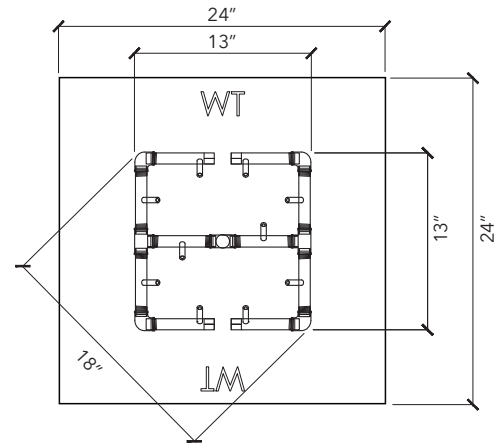
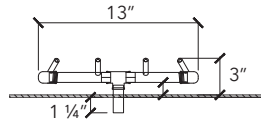

SKU (NG OR LP)	DESCRIPTION	SHIP WEIGHT	SHIP DIMENSIONS
CFB120NG CFB120LP	120K BTU Original Brass Burner	8 lbs	15" x 15" x 5"
Recommended parts: Plate: ALPL24S (square) • 3/4" Flex Line Kit • Optional 4x Support Collars			
CFB120NGALPL24S CFB120LPALPL24S	with 24" Square Plate	15 lbs	26" x 26" x 6"
CFB120NGALPL24SFK1 CFB120LPALPL24SFK1	with 24" Square Plate + 3/4" Flex Line Kit	18 lbs	26" x 26" x 6"
Compatible Ignition Systems: Push Button, 3 Volt, 24 Volt Spark Ignition, 24 Volt Hot Surface Ignition (SC)			

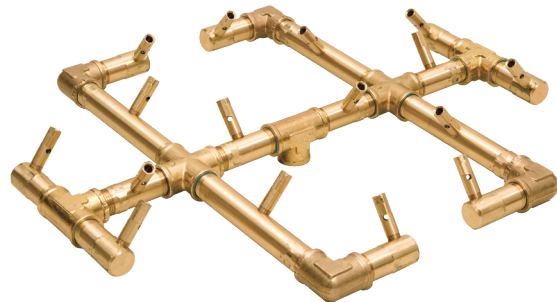

ORIGINAL CFB180

For 30" opening or larger

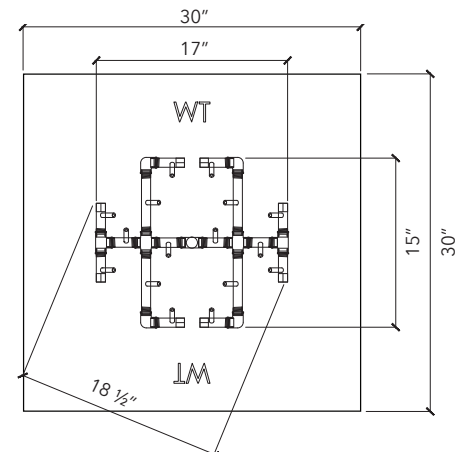
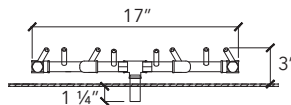

SKU (NG OR LP)	DESCRIPTION	SHIP WEIGHT	SHIP DIMENSIONS
CFB180NG CFB180LP	180K BTU Original Brass Burner	9 lbs	19" x 19" x 7"
Recommended parts: Plate: ALPL30S (square) • 3/4" Flex Line Kit • Optional 5x Support Collars			
CFB180NGALPL30S CFB180LPALPL30S	with 30" Square Plate	19 lbs	33" x 33" x 9"
CFB180NGALPL30SFK1 CFB180LPALPL30SFK1	with 30" Square Plate + 3/4" Flex Line Kit	22 lbs	33" x 33" x 9"
Compatible Ignition Systems: Push Button, 24 Volt Spark Ignition, 24 Volt Hot Surface Ignition (SC)			

COMPLETE THE FEATURE WITH MEDIA, PAGE 45

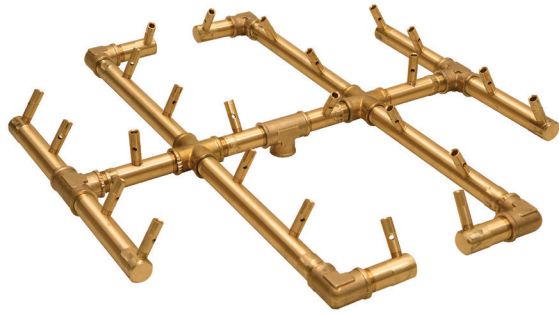

ORIGINAL CFB240

For 30" opening or larger

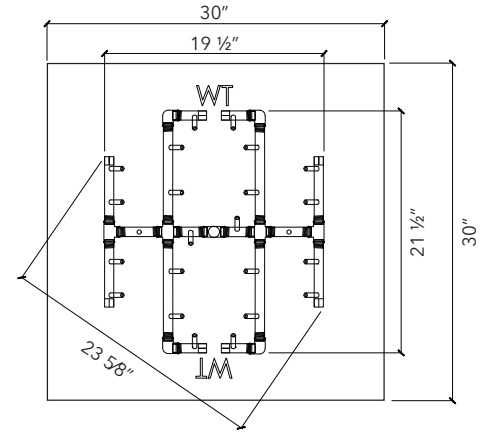
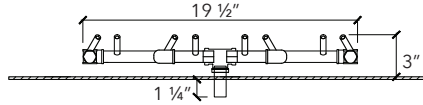

SKU (NG OR LP)	DESCRIPTION	SHIP WEIGHT	SHIP DIMENSIONS
CFB240NG CFB240LP	240K BTU Original Brass Burner	12 lbs	23" x 23" x 7"
Recommended parts: Plate: ALPL30S (square) • 3/4" Flex Line Kit • Optional 5x Support Collars			
CFB240NGALPL30S CFB240LPALPL30S	with 30" Square Plate	20 lbs	33" x 33" x 9"
CFB240NGALPL30SFK1 CFB240LPALPL30SFK1	with 30" Square Plate + 3/4" Flex Line Kit	23 lbs	33" x 33" x 9"
Compatible Ignition Systems: Push Button, 24 Volt Spark Ignition, 24 Volt Hot Surface Ignition (SC)			

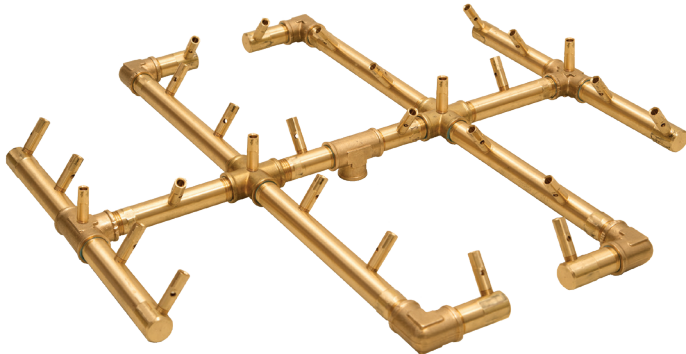

ORIGINAL CFB290

For 36" opening or larger

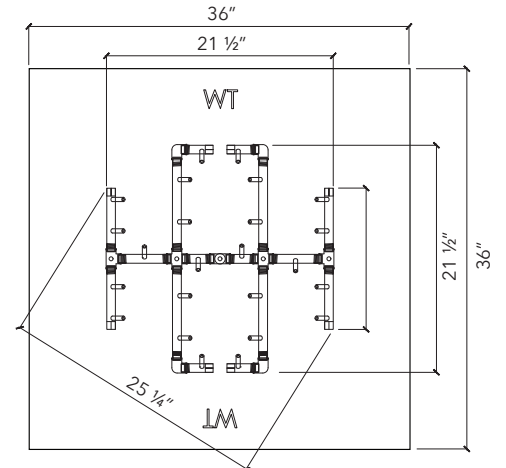
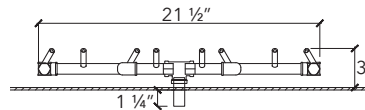

SKU (NG OR LP)	DESCRIPTION	SHIP WEIGHT	SHIP DIMENSIONS
CFB290NG CFB290LP	290K BTU Original Brass Burner	12 lbs	23" x 23" x 7"
Recommended parts: Plate: ALPL36S (square) • 3/4" Dual Flex Line Kit • Optional 6x Support Collars			
CFB290NGALPL36S CFB290LPALPL36S	with 36" Square Plate	40 lbs	38" x 38" x 7"
CFB290NGALPL36SFK2 CFB290LPALPL36SFK2	with 36" Square Plate + 3/4" Dual Flex Line Kit	44 lbs	38" x 38" x 7"
Compatible Ignition Systems: Push Button, 24 Volt Spark Ignition, 24 Volt Hot Surface Ignition (SC)			

SKU BREAKDOWN											
C		F	B	O	3	6	0	N	G	A	L
CROSSFIRE		BTU		Plate		Shape		Flex Line		Kit	
Brass Burner				or Pan		of Plate					

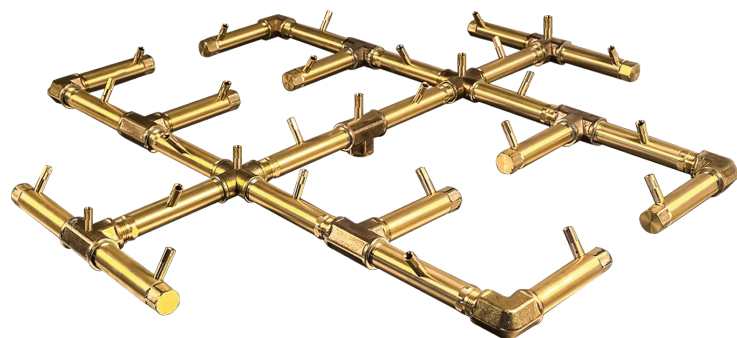

ORIGINAL CFB350

For 48" opening or larger

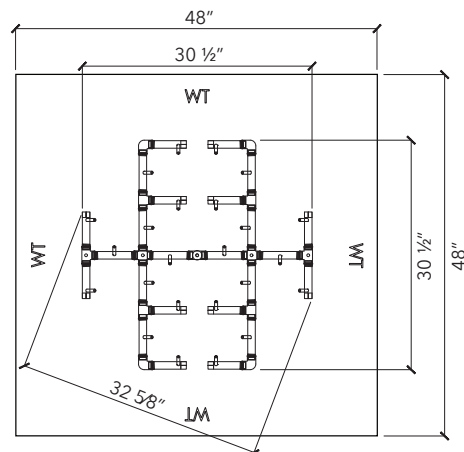
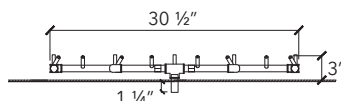

SKU (NG OR LP)	DESCRIPTION	SHIP WEIGHT	SHIP DIMENSIONS
CFB350NG CFB350LP	350K BTU Original Brass Burner	23 lbs	33" x 33" x 9"
Recommended parts: Plate: ALPL48S (square) • ¾" Dual Flex Line Kit • Optional 8x Support Collars			
CFB350NGALPL48S CFB350LPALPL48S	with 48" Square Plate	SHIPS FREIGHT	
CFB350NGALPL48SFK2 CFB350LPALPL48SFK2	with 48" Square Plate + ¾" Dual Flex Line Kit	SHIPS FREIGHT	
Compatible Ignition Systems: 24 Volt Spark Ignition, 24 Volt Hot Surface Ignition (HC)			



ORIGINAL CFB450

For 60" opening or larger

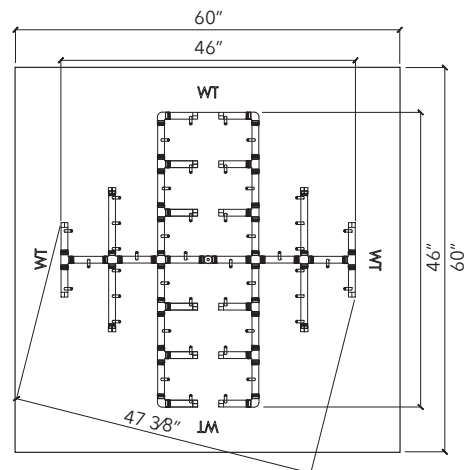
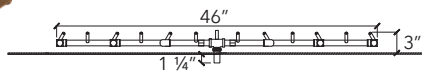

SKU (NG OR LP)	DESCRIPTION	SHIP WEIGHT	SHIP DIMENSIONS
CFB450NG CFB450LP	450K BTU Original Brass Burner	SHIPS FREIGHT	
Recommended parts: Plate: ALPL60S (square) • ¾" Dual Flex Line Kit • Optional 10x Support Collars			
CFB450NGALPL60S CFB450LPALPL60S	with 60" Square Plate	SHIPS FREIGHT	
CFB450NGALPL60SFK2 CFB450LPALPL60SFK2	with 60" Square Plate + ¾" Dual Flex Line Kit	SHIPS FREIGHT	
Compatible Ignition Systems: 24 Volt Spark Ignition, 24 Volt Hot Surface Ignition (HC)			

PAN AND PLATES AVAILABLE ON PAGE 30

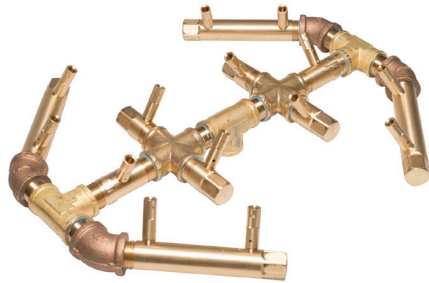

OCTAGONAL CFBO140

For 18" opening or larger

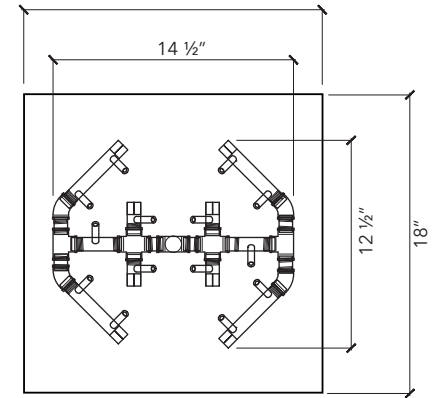
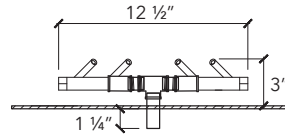

SKU (NG OR LP)	DESCRIPTION	SHIP WEIGHT	SHIP DIMENSIONS
CFBO140NG CFBO140LP	140K BTU Octagonal Brass Burner	9 lbs	19" x 15" x 5"
Recommended parts: Plate: ALPL18S (square) • 3/4" Flex Line Kit • Optional 3x Support Collars			
CFBO140NGALPL18S CFBO140LPALPL18S	with 18" Square Plate	13 lbs	20" x 20" x 6"
CFBO140NGALPL18SFK1 CFBO140LPALPL18SFK1	with 18" Square Plate + 3/4" Flex Line Kit	16 lbs	20" x 20" x 6"
Compatible Ignition Systems: Push Button, 24 Volt Spark Ignition, 24 Volt Hot Surface Ignition (SC)			

Images for reference only. Drawings provided within 1" of variance of burner measurements.

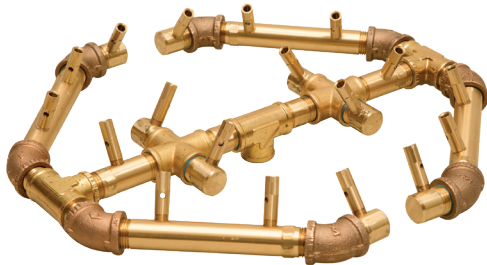

OCTAGONAL CFBO180

For 24" opening or larger

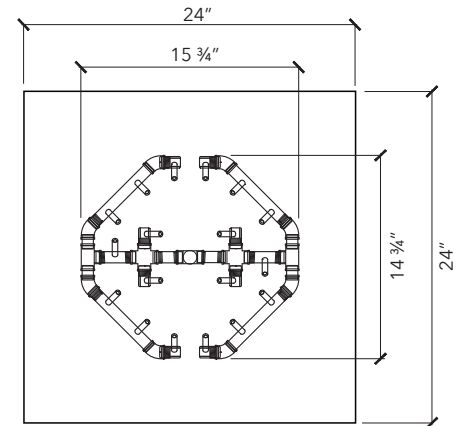
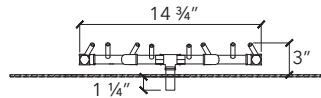

SKU (NG OR LP)	DESCRIPTION	SHIP WEIGHT	SHIP DIMENSIONS
CFBO180NG CFBO180LP	180K BTU Octagonal Brass Burner	10 lbs	19" x 15" x 5"
Recommended parts: Plate: ALPL24S (square) • 3/4" Flex Line Kit • Optional 4x Support Collars			
CFBO180NGALPL24S CFBO180LPALPL24S	with 24" Square Plate	17 lbs	26" x 26" x 6"
CFBO180NGALPL24SFK1 CFBO180LPALPL24SFK1	with 24" Square Plate + 3/4" Flex Line Kit	20 lbs	26" x 26" x 6"
Compatible Ignition Systems: Push Button, 24 Volt Spark Ignition, 24 Volt Hot Surface Ignition (SC)			

Images for reference only. Drawings provided within 1" of variance of burner measurements.

SKU BREAKDOWN		Octagonal (Burner Type)	Gas Type	Size of Plate	Flex Line Kit
		CROSSFIRE Brass Burner	BTU	Plate or Pan	Shape of Plate
		CFBO	360	NGALPL	42CFK2

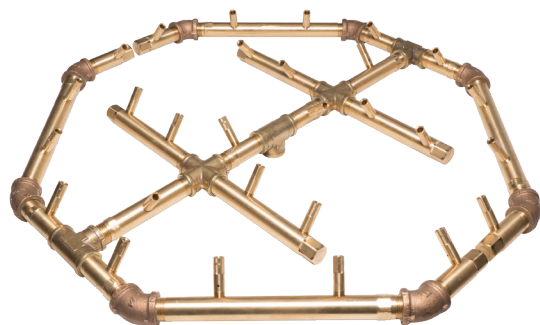

OCTAGONAL CFBO280

For 30" opening or larger

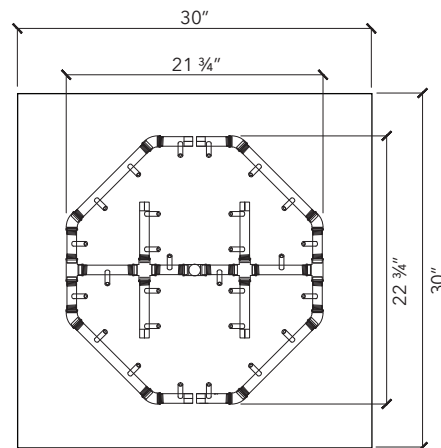
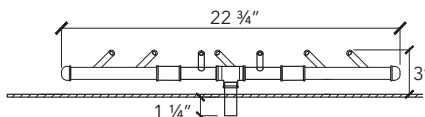

SKU (NG OR LP)	DESCRIPTION	SHIP WEIGHT	SHIP DIMENSIONS
CFBO280NG CFBO280LP	280K BTU Octagonal Brass Burner	13 lbs	25" x 25" x 7"
Recommended parts: Plate: ALPL30S (square) • 3/4" Dual Flex Line Kit • Optional 5x Support Collars			
CFBO280NGALPL30S CFBO280LPALPL30S	with 30" Square Plate	23 lbs	32" x 32" x 8"
CFBO280NGALPL30SFK2 CFBO280LPALPL30SFK2	with 30" Square Plate + 3/4" Dual Flex Line Kit	30 lbs	32" x 32" x 8"
Compatible Ignition Systems: Push Button, 24 Volt Spark Ignition, 24 Volt Hot Surface Ignition (HC)			

Images for reference only. Drawings provided within 1" of variance of burner measurements.

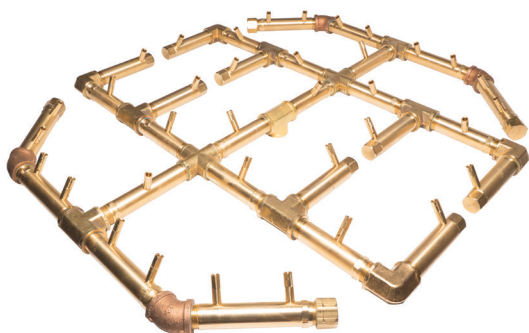

OCTAGONAL CFBO360

For 42" opening or larger

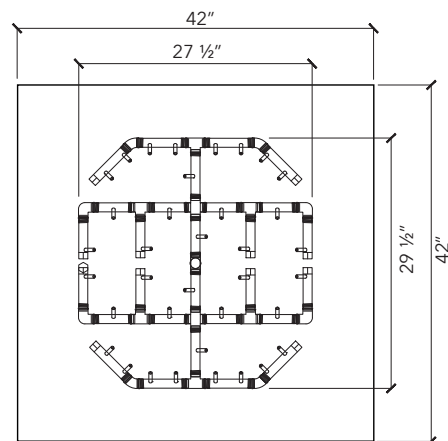
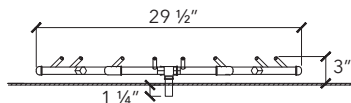

SKU (NG OR LP)	DESCRIPTION	SHIP WEIGHT	SHIP DIMENSIONS
CFBO360NG CFB360LP	360K BTU Octagonal Brass Burner	22 lbs	31" x 31" x 7"
Recommended parts: Plate: ALPL42S (square) • ¾" Dual Flex Line Kit • Optional 7x Support Collars			
CFBO360NGALPL42S CFBO360LPALPL42S	with 42" Square Plate	SHIPS FREIGHT	
CFBO360NGALPL42SFK2 CFBO360LPALPL42SFK2	with 42" Square Plate + ¾" Dual Flex Line Kit	SHIPS FREIGHT	
Compatible Ignition Systems: 24 Volt Spark Ignition, 24 Volt Hot Surface Ignition (HC)			

Images for reference only. Drawings provided within 1" of variance of burner measurements.

LIGHT IT UP! IGNITION SYSTEMS START ON PAGE 43



OPTIONS FOR RECTANGULAR OPENINGS

Designed for rectangular fire features, these CROSSFIRE® Brass Burners range from 90K to 480K BTUs.

Need a different size or shape?
We're happy to help. Call our Flame
Consultants at 877 556 5255

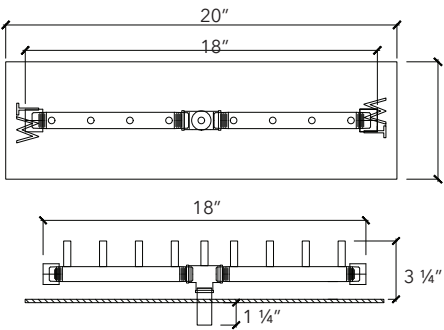
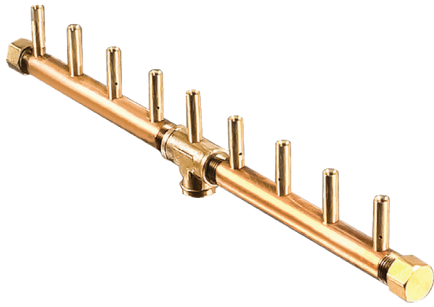

LINEAR CFBL90
For 20" x 6" opening or larger

SKU (NG OR LP)	DESCRIPTION	SHIP WEIGHT	SHIP DIMENSIONS
CFBL90NG CFBL90LP	90K BTU Linear Brass Burner	4 lbs	25" x 5" x 5"
Recommended parts: Plate: ALPL206 • 3/4" Flex Line Kit • Optional 3x Support Collars			
CFBL90NGALPL206 CFBL90LPALPL206	with 20" x 6" Rectangle Plate	7 lbs	25" x 9" x 7"
CFBL90NGALPL206FK1 CFBL90LPALPL206FK1	with 20" x 6" Plate + 3/4" Flex Line Kit	10 lbs	25" x 9" x 7"
Compatible Ignition Systems: Push Button, 3 Volt, 24 Volt Spark Ignition, 24 Volt Hot Surface Ignition (SC)			

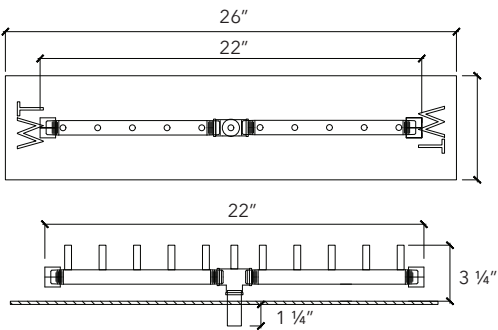
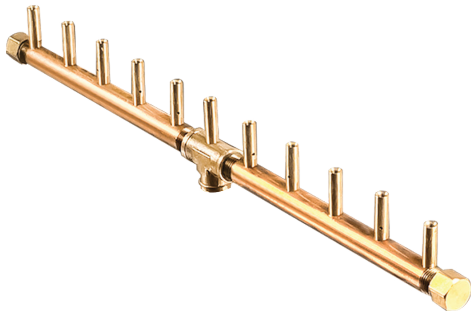

LINEAR CFBL110
For 26" x 6" opening or larger

SKU (NG OR LP)	DESCRIPTION	SHIP WEIGHT	SHIP DIMENSIONS
CFBL110NG CFBL110LP	110K BTU Linear Brass Burner	5 lbs	25" x 5" x 5"
Recommended parts: Plate: ALPL266 • 3/4" Flex Line Kit • Optional 3x Support Collars			
CFBL110NGALPL266 CFBL110LPALPL266	with 26" x 6" Rectangle Plate	10 lbs	31" x 7" x 7"
CFBL110NGALPL266FK1 CFBL110LPALPL266FK1	with 26" x 6" Plate + 3/4" Flex Line Kit	13 lbs	31" x 7" x 7"
Compatible Ignition Systems: Push Button, 3 Volt, 24 Volt Spark Ignition, 24 Volt Hot Surface Ignition (SC)			

COMPLETE THE FEATURE WITH MEDIA, PAGE 45

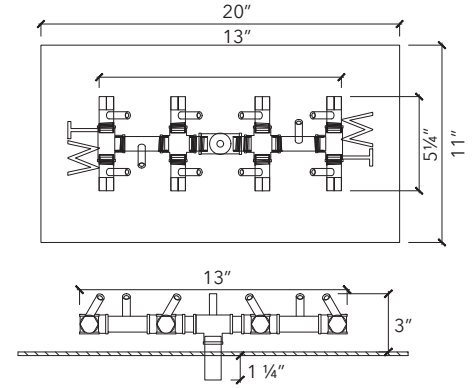

TREE-STYLE CFBT110

For 20" x 11" opening or larger

SKU (NG OR LP)	DESCRIPTION	SHIP WEIGHT	SHIP DIMENSIONS
CFBT110NG CFBT110LP	110K BTU Tree-Style Brass Burner	6 lbs	15" x 15" x 5"
Recommended parts: Plate: ALPL2011 • 3/4" Flex Line Kit • Optional 3x Support Collars			
CFBT110NGALPL2011 CFBT110LPALPL2011	with 20" x 11" Rectangle Plate	12 lbs	21" x 21" x 7"
CFBT110NGALPL2011FK1 CFBT110LPALPL2011FK1	with 20" x 11" Plate + 3/4" Flex Line Kit	15 lbs	21" x 21" x 7"
Compatible Ignition Systems: Push Button, 3 Volt, 24 Volt Spark Ignition, 24 Volt Hot Surface Ignition (SC)			

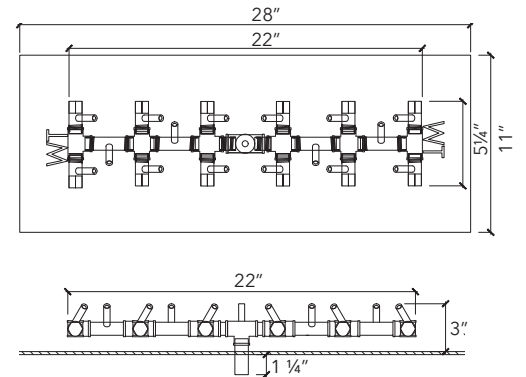

TREE-STYLE CFBT170

For 28" x 11" opening or larger

SKU (NG OR LP)	DESCRIPTION	SHIP WEIGHT	SHIP DIMENSIONS
CFBT170NG CFBT170LP	170K BTU Tree-Style Brass Burner	8 lbs	25" x 9" x 7"
Recommended parts: Plate: ALPL2811 • 3/4" Flex Line Kit • Optional 4x Support Collars			
CFBT170NGALPL2811 CFBT170LPALPL2811	with 28" x 11" Rectangle Plate	16 lbs	37" x 13" x 13"
CFBT170NGALPL2811FK1 CFBT170LPALPL2811FK1	with 28" x 11" Plate + 3/4" Flex Line Kit	15 lbs	37" x 13" x 13"
Compatible Ignition Systems: Push Button, 24 Volt Spark Ignition, 24 Volt Hot Surface Ignition (SC)			

SKU BREAKDOWN	Octagonal (Burner Type)			Gas Type		Size of Plate		Flex Line Kit											
	C	F	B	O	3	6	0	N	G	A	L	P	L	4	2	C	F	K	2
	CROSSFIRE Brass Burner			BTU						Plate or Pan				Shape of Plate					

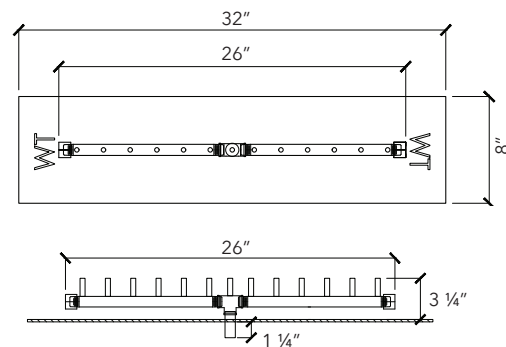
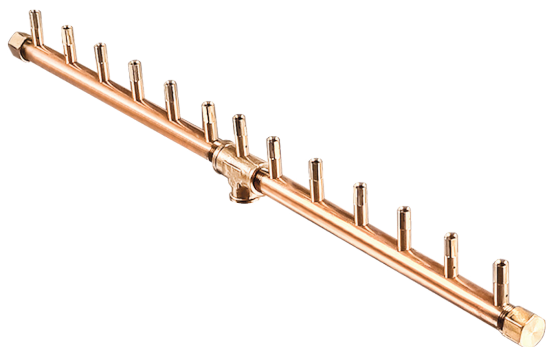

LINEAR CFBL130

For 32" x 8" opening or larger

SKU (NG OR LP)	DESCRIPTION	SHIP WEIGHT	SHIP DIMENSIONS
CFBL130NG CFBL130LP	130K BTU Linear Brass Burner	5 lbs	37" x 5" x 5"
Recommended parts: Plate: ALPL328 • 3/4" Flex Line Kit • Optional 4x Support Collars			
CFBL130NGALPL328 CFBL130LPALPL328	with 32" x 8" Rectangle Plate	11 lbs	37" x 13" x 13"
CFBL130NGALPL328FK1 CFBL130LPALPL328FK1	with 32" x 8" Plate + 3/4" Flex Line Kit	14 lbs	37" x 13" x 13"
Compatible Ignition Systems: Push Button, 24 Volt Spark Ignition, 24 Volt Hot Surface Ignition (SC)			

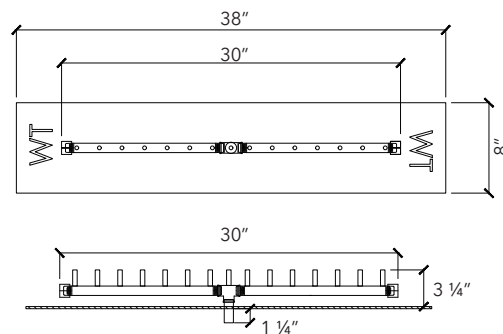
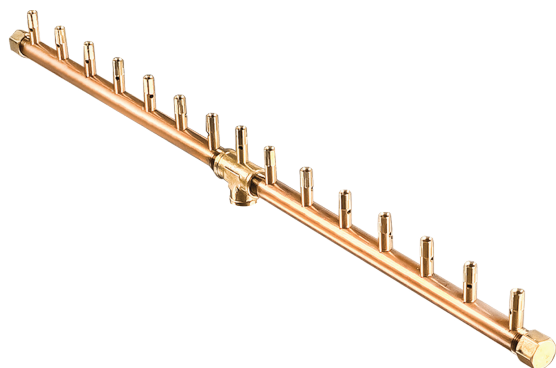

LINEAR CFBL150

For 38" x 8" opening or larger

SKU (NG OR LP)	DESCRIPTION	SHIP WEIGHT	SHIP DIMENSIONS
CFBL150NG CFBL150LP	150K BTU Linear Brass Burner	5 lbs	37" x 5" x 5"
Recommended parts: Plate: ALPL388 • 3/4" Flex Line Kit • Optional 4x Support Collars			
CFBL150NGALPL388 CFBL150LPALPL388	with 38" x 8" Rectangle Plate	14 lbs	41" x 9" x 9"
CFBL150NGALPL388FK1 CFBL150LPALPL388FK1	with 38" x 8" Plate + 3/4" Flex Line Kit	17 lbs	41" x 9" x 9"
Compatible Ignition Systems: Push Button, 24 Volt Spark Ignition, 24 Volt Hot Surface Ignition (SC)			

PAN AND PLATES AVAILABLE ON PAGE 30

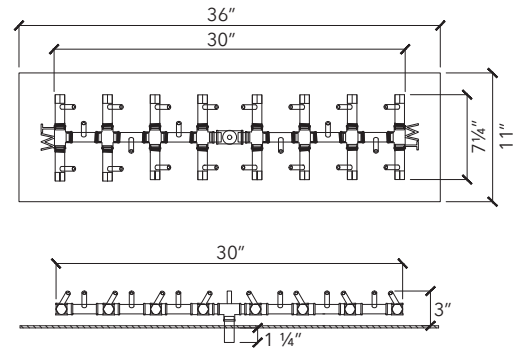

TREE-STYLE CFBT230
For 36" x 11" opening or larger

SKU (NG OR LP)	DESCRIPTION	SHIP WEIGHT	SHIP DIMENSIONS
CFBT230NG CFBT230LP	230K BTU Tree-Style Brass Burner	10 lbs	37" x 13" x 13"
Recommended parts: Plate: ALPL3611 • 3/4" Flex Line Kit • Optional 5x Support Collars			
CFBT230NGALPL3611 CFBT230LPALPL3611	with 36" x 11" Rectangle Plate	19 lbs	37" x 13" x 13"
CFBT230NGALPL3611FK1 CFBT230LPALPL3611FK1	with 36" x 11" Plate + 3/4" Flex Line Kit	22 lbs	37" x 13" x 13"
Compatible Ignition Systems: Push Button, 24 Volt Spark Ignition, 24 Volt Hot Surface Ignition (SC)			

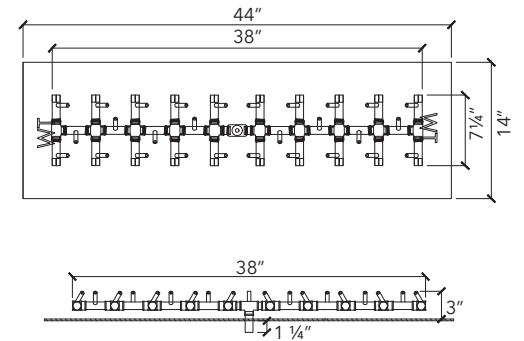

TREE-STYLE CFBT290
For 44" x 14" opening or larger

SKU (NG OR LP)	DESCRIPTION	SHIP WEIGHT	SHIP DIMENSIONS
CFBT290NG CFBT290LP	290K BTU Tree-Style Brass Burner	12 lbs	49" x 9" x 9"
Recommended parts: Plate: ALPL4414 • 3/4" Dual Flex Line Kit • Optional 5x Support Collars			
CFBT290NGALPL4414 CFBT290LPALPL4414	with 44" x 14" Rectangle Plate	30 lbs	49" x 17" x 17"
CFBT290NGALPL4414FK2 CFBT290LPALPL4414FK2	with 44" x 14" Plate + 3/4" Dual Flex Line Kit	37 lbs	49" x 17" x 17"
Compatible Ignition Systems: Push Button, 24 Volt Spark Ignition, 24 Volt Hot Surface Ignition (SC)			

SKU BREAKDOWN	Octagonal (Burner Type)				Gas Type		Size of Plate		Flex Line Kit									
	C	F	B	O	3	6	0	N	G	A	L	P	L	4	2	C	F	K
	CROSSFIRE Brass Burner				BTU		Plate or Pan		Shape of Plate									

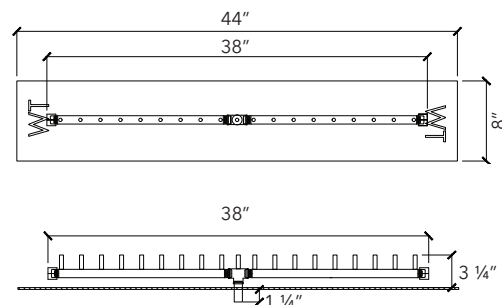
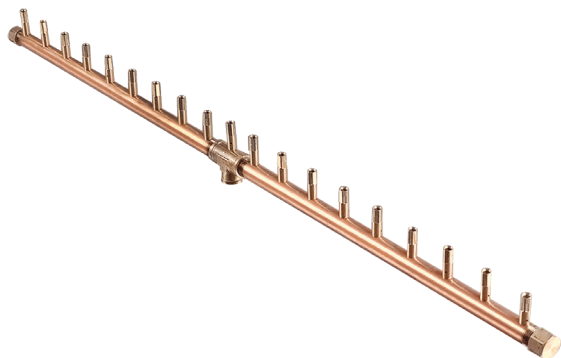

LINEAR CFBL190 For 44" x 8" opening or larger

SKU (NG OR LP)	DESCRIPTION	SHIP WEIGHT	SHIP DIMENSIONS
CFBL190NG CFBL190LP	190K BTU Linear Brass Burner	6 lbs	49" x 5" x 5"
Recommended parts: Plate: ALPL448 • 3/4" Flex Line Kit • Optional 5x Support Collars			
CFBL190NGALPL448 CFBL190LPALPL448	with 44" x 8" Rectangle Plate	17 lbs	49" x 9" x 9"
CFBL190NGALPL448FK1 CFBL190LPALPL448FK1	with 44" x 8" Plate + 3/4" Flex Line Kit	20 lbs	49" x 9" x 9"
Compatible Ignition Systems: Push Button, 24 Volt Spark Ignition, 24 Volt Hot Surface Ignition (SC)			

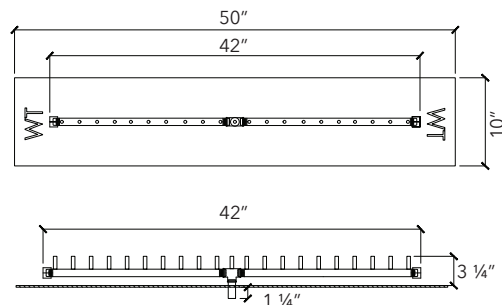
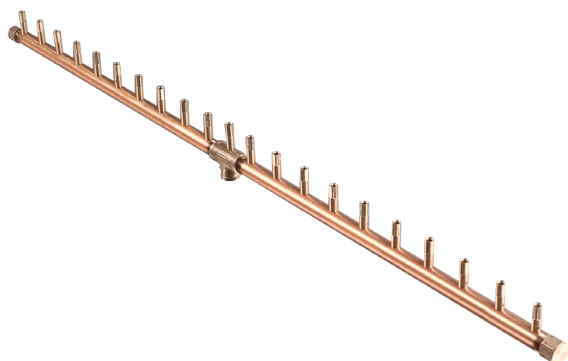

LINEAR CFBL210 For 50" x 10" opening or larger

SKU (NG OR LP)	DESCRIPTION	SHIP WEIGHT	SHIP DIMENSIONS
CFBL210NG CFBL210LP	210K BTU Linear Brass Burner	7 lbs	49" x 5" x 5"
Recommended parts: Plate: ALPL5010 • 3/4" Flex Line Kit • Optional 6x Support Collars			
CFBL210NGALPL5010 CFBL210LPALPL5010	with 50" x 10" Rectangle Plate	23 lbs	61" x 9" x 9"
CFBL210NGALPL5010FK1 CFBL210LPALPL5010FK1	with 50" x 10" Plate + 3/4" Flex Line Kit	26 lbs	61" x 9" x 9"
Compatible Ignition Systems: Push Button, 24 Volt Spark Ignition, 24 Volt Hot Surface Ignition (SC)			

LIGHT IT UP! IGNITION SYSTEMS START ON PAGE 43

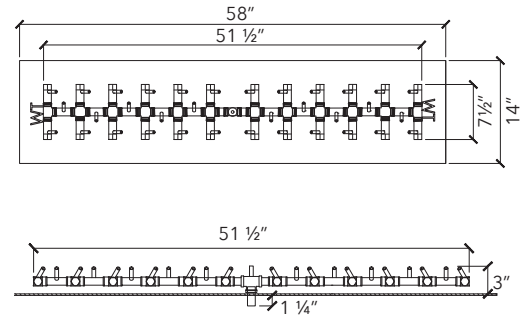
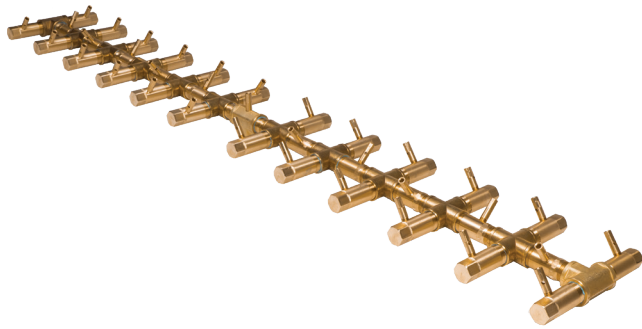

TREE-STYLE CFBT350

For 58" x 14" opening or larger

SKU (NG OR LP)	DESCRIPTION	SHIP WEIGHT	SHIP DIMENSIONS
CFBT350NG CFBT350LP	350K BTU Tree-Style Brass Burner	20 lbs	61" x 9" x 9"
Recommended parts: Plate: ALPL5814 • ¾" Dual Flex Line Kit • Optional 7x Support Collars			
CFBT350NGALPL5814 CFBT350LPALPL5814	with 58" x 14" Rectangle Plate	SHIPS FREIGHT	
CFBT350NGALPL5814FK2 CFBT350LPALPL5814FK2	with 58" x 14" Plate + ¾" Dual Flex Line Kit	SHIPS FREIGHT	
Compatible Ignition Systems: 24 Volt Hot Surface Ignition (HC)			

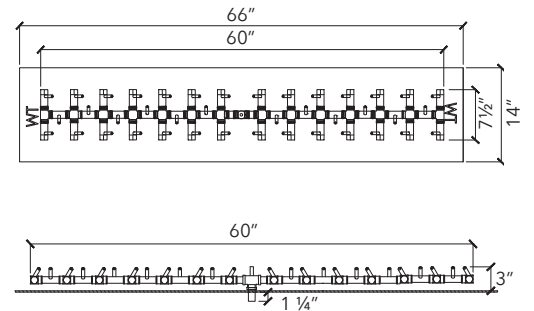

TREE-STYLE CFBT410

For 66" x 14" opening or larger

SKU (NG OR LP)	DESCRIPTION	SHIP WEIGHT	SHIP DIMENSIONS
CFBT410NG CFBT410LP	410K BTU Tree-Style Brass Burner	20 lbs	61" x 61" x 9"
Recommended parts: Plate: ALPL6614 • ¾" Dual Flex Line Kit • Optional 8x Support Collars			
CFBT410NGALPL6614 CFBT410LPALPL6614	with 66" x 14" Rectangle Plate	SHIPS FREIGHT	
CFBT410NGALPL6614FK2 CFBT410LPALPL6614FK2	with 66" x 14" Plate + ¾" Dual Flex Line Kit	SHIPS FREIGHT	
Compatible Ignition Systems: 24 Volt Hot Surface Ignition (HC)			

SKU BREAKDOWN	Octagonal (Burner Type)		Gas Type		Size of Plate		Flex Line Kit											
	C	F	B	O	3	6	N	G	A	L	P	L	4	2	C	F	K	2
	CROSSFIRE Brass Burner				BTU		Plate or Pan				Shape of Plate							

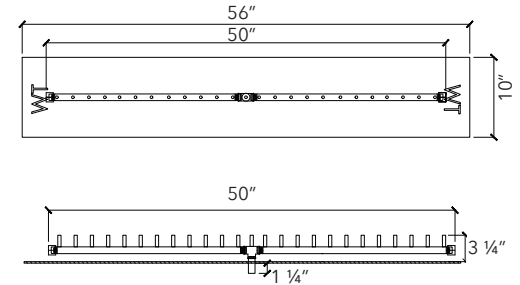
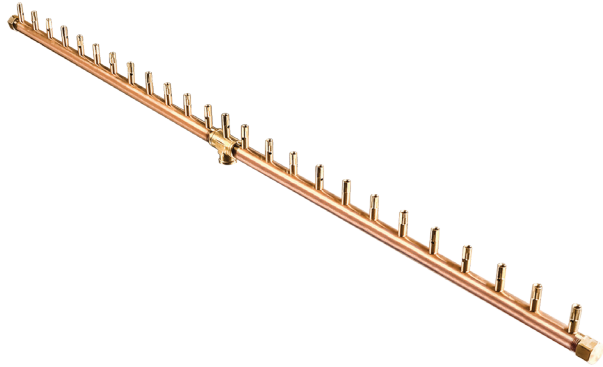

LINEAR CFBL250

For 56" x 10" opening or larger

SKU (NG OR LP)	DESCRIPTION	SHIP WEIGHT	SHIP DIMENSIONS
CFBL250NG CFBL250LP	250K BTU Linear Brass Burner	7 lbs	61" x 5" x 5"
Recommended parts: Plate: ALPL5610 • 3/4" Dual Flex Line Kit • Optional 7x Support Collars			
CFBL250NGALPL5610 CFBL250LPALPL5610	with 56" x 10" Rectangle Plate	25 lbs	61" x 9" x 9"
CFBL250NGALPL5610FK2 CFBL250LPALPL5610FK2	with 56" x 10" Plate + 3/4" Dual Flex Line Kit	32 lbs	61" x 9" x 9"
Compatible Ignition Systems: Push Button, 24 Volt Spark Ignition, 24 Volt Hot Surface Ignition (SC)			

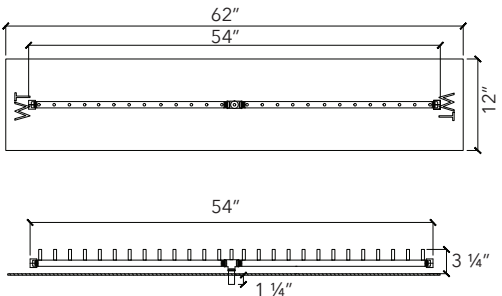
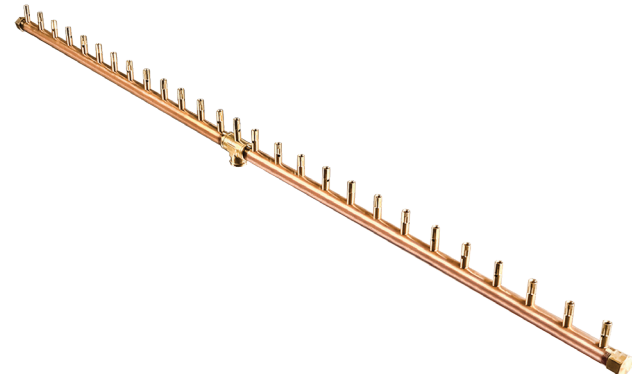

LINEAR CFBL270

For 62" x 12" opening or larger

SKU (NG OR LP)	DESCRIPTION	SHIP WEIGHT	SHIP DIMENSIONS
CFBL270NG CFBL270LP	270K BTU Linear Brass Burner	8 lbs	61" x 5" x 5"
Recommended parts: Plate: ALPL6212 • ¾" Dual Flex Line Kit • Optional 8x Support Collars			
CFBL270NGALPL6212 CFBL270LPALPL6212	with 62" x 12" Rectangle Plate	SHIPS FREIGHT	
CFBL270NGALPL6212FK2 CFBL270LPALPL6212FK2	with 62" x 12" Plate + ¾" Dual Flex Line Kit	SHIPS FREIGHT	
Compatible Ignition Systems: Push Button, 24 Volt Spark Ignition, 24 Volt Hot Surface Ignition (SC)			

SKU BREAKDOWN											
C	F	B	O	3	6	0	N	G	A	L	P
CROSSFIRE Brass Burner			BTU			Plate or Pan			Shape of Plate		

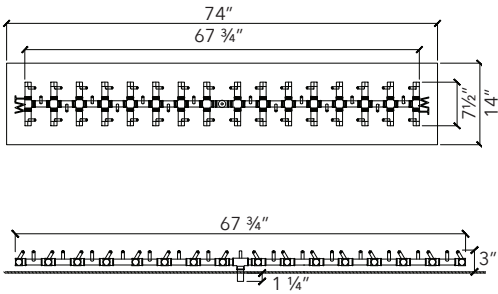

TREE-STYLE CFBT470
For 74" x 14" opening or larger

SKU (NG OR LP)	DESCRIPTION	SHIP WEIGHT	SHIP DIMENSIONS
CFBT470NG CFBT470LP	470K BTU Tree-Style Brass Burner	SHIPS FREIGHT	
Recommended parts: Plate: ALPL7414 • ¾" Dual Flex Line Kit • Optional 9x Support Collars			
CFBT470NGALPL7414 CFBT470LPALPL7414	with 74" x 14" Rectangle Plate	SHIPS FREIGHT	
CFBT470NGALPL7414FK2 CFBT470LPALPL7414FK2	with 74" x 14" Plate + ¾" Dual Flex Line Kit	SHIPS FREIGHT	
Compatible Ignition Systems: 24 Volt Hot Surface Ignition (HC)			

PLATES & PANS

Cut from aluminum using state-of-the-art water jet technology, Warming Trends® plates and pans are corrosion resistant and include drainage vents.

CIRCULAR PLATES and PANS



Plates

SKU	DESCRIPTION	SHIP WEIGHT + DIMENSIONS	
ALPL18C	18" Circular	4 lbs	19" x 19" x 7"
ALPL24C	24" Circular	5 lbs	25" x 25" x 7"
ALPL30C	30" Circular	8 lbs	31" x 31" x 7"
ALPL36C	36" Circular	12 lbs	37" x 37" x 9"
ALPL42C	42" Circular	SHIPS FREIGHT	
ALPL48C	48" Circular	SHIPS FREIGHT	
ALPL60C	60" Circular	SHIPS FREIGHT	
ALPL12-17C	12" - 17" Circular	4 lbs	19" x 19" x 7"
ALPL19-23C	19" - 23" Circular	5 lbs	25" x 25" x 7"
ALPL25-29C	25" - 29" Circular	8 lbs	31" x 31" x 7"
ALPL31-35C	31" - 35" Circular	12 lbs	37" x 37" x 9"
ALPL37-41C	37" - 41" Circular	SHIPS FREIGHT	
ALPL43-47C	43" - 47" Circular	SHIPS FREIGHT	
ALPL49-59C	49" - 49" Circular	SHIPS FREIGHT	
ALPL61-66C	61" - 66" Circular	SHIPS FREIGHT	
ALPL67-72C	67" - 72" Circular	SHIPS FREIGHT	
ALPL73-80C	73" - 80" Circular	SHIPS FREIGHT	



Pans (Pans include 2" welded sidewall)

SKU	DESCRIPTION	SHIP WEIGHT + DIMENSIONS	
ALPAN18C	18" Circular	7 lbs	19" x 19" x 7"
ALPAN24C	24" Circular	9 lbs	25" x 25" x 7"
ALPAN30C	30" Circular	12 lbs	31" x 31" x 7"
ALPAN36C	36" Circular	17 lbs	37" x 37" x 9"
ALPAN42C	42" Circular	SHIPS FREIGHT	
ALPAN48C	48" Circular	SHIPS FREIGHT	
ALPAN60C	60" Circular	SHIPS FREIGHT	
ALPAN12-17C	12" - 17" Circular	6 lbs	19" x 19" x 7"
ALPAN19-23C	19" - 23" Circular	9 lbs	25" x 25" x 7"
ALPAN25-29C	25" - 29" Circular	12 lbs	31" x 31" x 7"
ALPAN31-35C	31" - 35" Circular	16 lbs	37" x 37" x 9"
ALPAN37-41C	37" - 41" Circular	SHIPS FREIGHT	
ALPAN43-47C	43" - 47" Circular	SHIPS FREIGHT	
ALPAN49-59C	49" - 59" Circular	SHIPS FREIGHT	



SQUARE PLATES and PANS

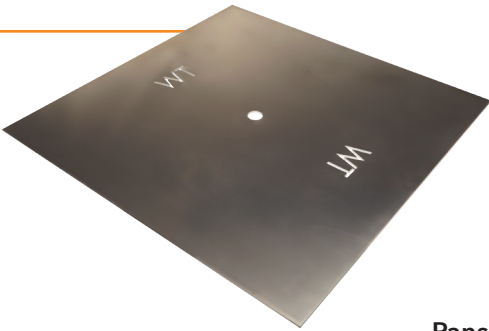

Plates

SKU	DESCRIPTION	SHIP WEIGHT + DIMENSIONS	
ALPL18S	18" Square	4 lbs	21" x 21" x 7"
ALPL24S	24" Square	7 lbs	27" x 27" x 7"
ALPL30S	30" Square	10 lbs	33" x 33" x 9"
ALPL36S	36" Square	15 lbs	39" x 39" x 7"
ALPL42S	42" Square	SHIPS FREIGHT	
ALPL48S	48" Square	SHIPS FREIGHT	
ALPL60S	60" Square	SHIPS FREIGHT	
ALPL12-17S	12" - 17" Square	4 lbs	19" x 19" x 7"
ALPL19-23S	19" - 23" Square	7 lbs	25" x 25" x 7"
ALPL25-29S	25" - 29" Square	10 lbs	31" x 31" x 7"
ALPL31-35S	31" - 35" Square	15 lbs	37" x 37" x 9"
ALPL37-41S	37" - 41" Square	SHIPS FREIGHT	
ALPL43-47S	43" - 47" Square	SHIPS FREIGHT	
ALPL49-59S	49" - 59" Square	SHIPS FREIGHT	
ALPL61-66S	61" - 66" Square	SHIPS FREIGHT	
ALPL67-72S	67" - 72" Square	SHIPS FREIGHT	
ALPL73-80S	73" - 80" Square	SHIPS FREIGHT	

Pans (Pans include 2" welded sidewall)

SKU	DESCRIPTION	SHIP WEIGHT + DIMENSIONS	
ALPAN18S	18" Square	8 lbs	21" x 21" x 7"
ALPAN24S	24" Square	11 lbs	27" x 27" x 7"
ALPAN30S	30" Square	15 lbs	33" x 33" x 9"
ALPAN36S	36" Square	20 lbs	39" x 39" x 7"
ALPAN42S	42" Square	SHIPS FREIGHT	
ALPAN48S	48" Square	SHIPS FREIGHT	
ALPAN60S	60" Square	SHIPS FREIGHT	
ALPAN12-17S	12" - 17" Square	7 lbs	19" x 19" x 7"
ALPAN19-23S	19" - 23" Square	10 lbs	25" x 25" x 7"
ALPAN25-29S	25" - 29" Square	14 lbs	31" x 31" x 7"
ALPAN31-35S	31" - 35" Square	19 lbs	37" x 37" x 9"
ALPAN37-41S	37" - 41" Square	SHIPS FREIGHT	
ALPAN43-47S	43" - 47" Square	SHIPS FREIGHT	
ALPAN49-59S	49" - 59" Square	SHIPS FREIGHT	



READY-TO-FINISH KITS

Aluminum frames covered with concrete board, ready to be easily and quickly completed with your choice of media or veneer.

Simply place on site, connect to the gas supply, add stone or other veneer and your fire feature is complete.

Need a different size or shape?
We're happy to help. Call our Flame Consultants at 877 556 5255

RECTANGULAR LINEAR READY-TO-FINISH KITS

TECH TIP

Ready-to-Finish Kits come with a Fire Pit Vent Kit (FPVK) but they do not come pre-installed as placement and installation depends on veneer. Vents are to be installed by contractor on site.



FR6036 shown

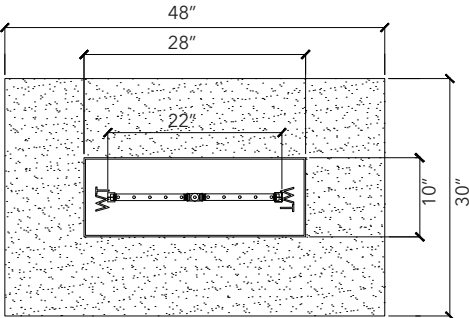

FR4830NG | FR4830LP

48" L x 30" W x 18" H Aluminum Frame with Concrete Board Attached
CFBL110 22" Linear Brass Burner
28" x 10" Aluminum Pan with 2" Sidewalls
Fire Pit Vent Kit
3/4" Flex Line Kit
Key Valve Extension
Ignition systems available: Push Button, 3 Volt, 24 Volt Spark Ignition, 24 Volt Hot Surface Ignition (SC)

SHIPS FREIGHT

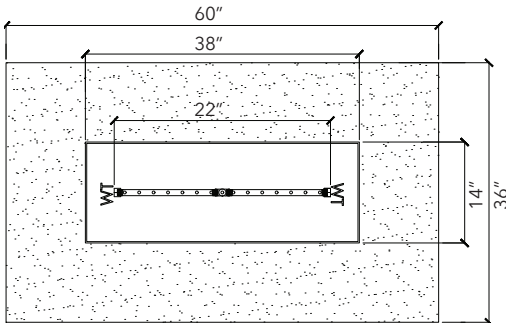

FR6036NG | FR6036LP

60" L x 36" W x 18" H Aluminum Frame with Concrete Board Attached
CFBL150 30" Linear Brass Burner
38" x 14" Aluminum Pan with 2" Sidewalls
Fire Pit Vent Kit
3/4" Flex Line Kit
Key Valve Extension
Ignition systems available: Push Button, 24 Volt Spark Ignition, 24 Volt Hot Surface Ignition (SC)

SHIPS FREIGHT

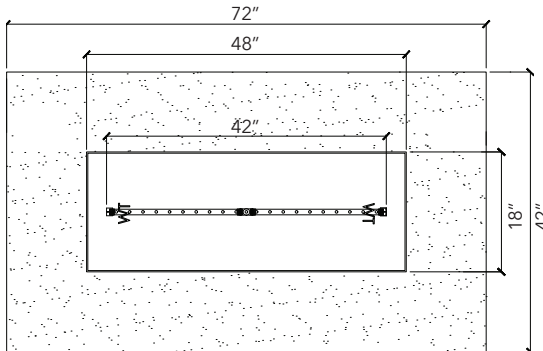

FR7242NG | FR7242LP

72" L x 42" W x 18" H Aluminum Frame with Concrete Board Attached
CFBL210 40" Linear Brass Burner
48" x 18" Aluminum Pan with 2" Sidewalls
Fire Pit Vent Kit
3/4" Flex Line Kit
Key Valve Extension
Ignition systems available: Push Button, 24 Volt Spark Ignition, 24 Volt Hot Surface Ignition (SC)

SHIPS FREIGHT

FIRESTORM® STEEL LOG

Handcrafted, one-of-a-kind steel gas log features an integrated linear burner and is sized perfectly for the FR6036 Rectangular Ready-to-Finish Kit.

Custom designs and sizes available.

See page 68 for more information or call us at 877 556 5255



RECTANGULAR TREE- STYLE READY-TO-FINISH KITS



FRT6036 shown

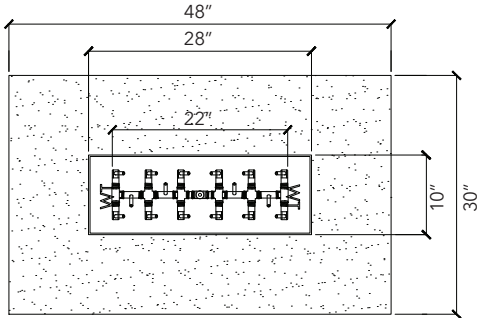

FRT4830NG FRT4830LP	
48" L x 30" W x 18" H Aluminum Frame with Concrete Board Attached CFBT170 Tree-Style Brass Burner 28" x 10" Aluminum Pan with 2" Sidewalls Fire Pit Vent Kit 3/4" Flex Line Kit Key Valve Extension Ignition systems available: Push Button, 24 Volt Spark Ignition, 24 Volt Hot Surface Ignition (SC)	SHIPS FREIGHT

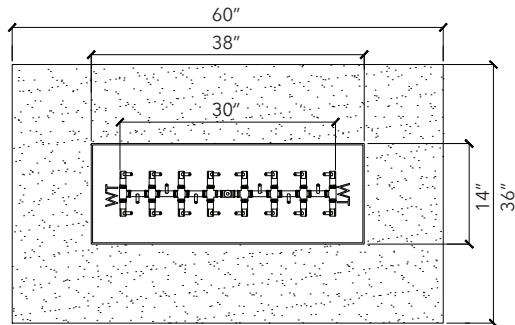

FRT6036NG FRT6036LP	
60" L x 36" W x 18" H Aluminum Frame with Concrete Board Attached CFBT230 Tree-Style Brass Burner 38" x 14" Aluminum Pan with 2" Sidewalls Fire Pit Vent Kit 3/4" Flex Line Kit Key Valve Extension Ignition systems available: Push Button, 24 Volt Spark Ignition, 24 Volt Hot Surface Ignition (SC)	SHIPS FREIGHT

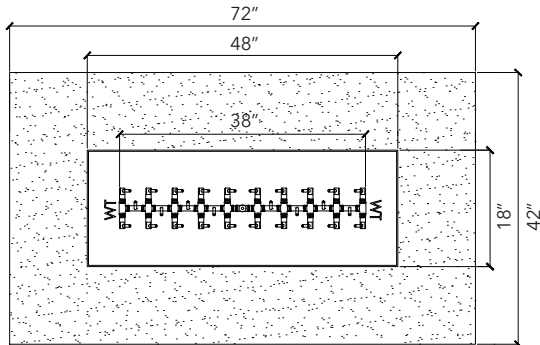

FRT7242NG FRT7242LP	
72" L x 42" W x 18" H Aluminum Frame with Concrete Board Attached CFBT290 Tree-Style Brass Burner 48" x 18" Aluminum Pan with 2" Sidewalls Fire Pit Vent Kit 3/4" Dual Flex Line Kit Key Valve Extension Ignition systems available: Push Button, 24 Volt Spark Ignition, 24 Volt Hot Surface Ignition (SC)	SHIPS FREIGHT



CUSTOM READY-TO-FINISH KITS

Your design is custom. Your fire feature should be, too.

Every day Warming Trends® designs and manufactures truly custom fire feature solutions.

Let us create a custom feature for you.
We'd love to help. **877 556 5255**

OCTAGONAL READY-TO-FINISH KITS

TECH TIP

Ready-to-Finish Kits come with a Fire Pit Vent Kit (FPVK) but they do not come pre-installed as placement and installation depends on veneer. Vents are to be installed by contractor on site.

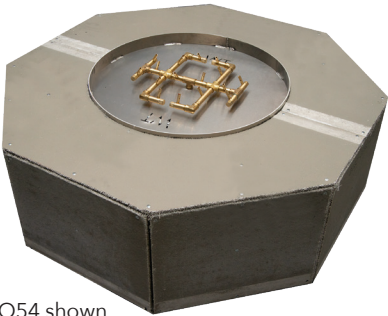

FO54 shown

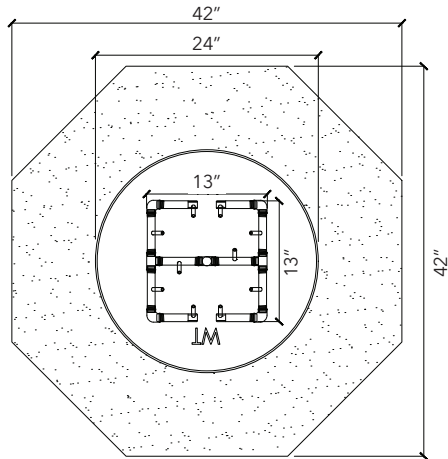

FO42NG | FO42LP

42" W x 18" H Aluminum Frame with Concrete Board Attached
CFB120 Original Brass Burner
24" Aluminum Pan with 2" Sidewalls
Fire Pit Vent Kit
¾" Flex Line Kit
Key Valve Extension
Ignition systems available: Push Button, 3 Volt, 24 Volt Spark Ignition, 24 Volt Hot Surface Ignition

SHIPS FREIGHT

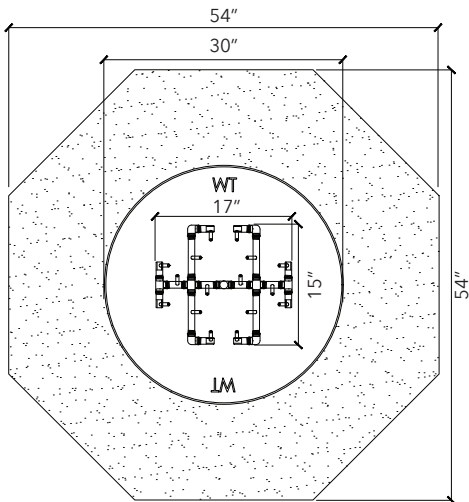

FO54NG | FO54LP

54" W x 18" H Aluminum Frame with Concrete Board Attached
CFB180 Original Brass Burner
30" Aluminum Pan with 2" Sidewalls
Fire Pit Vent Kit
¾" Flex Line Kit
Key Valve Extension
Ignition systems available: Push Button, 24 Volt Spark Ignition, 24 Volt Hot Surface Ignition

SHIPS FREIGHT

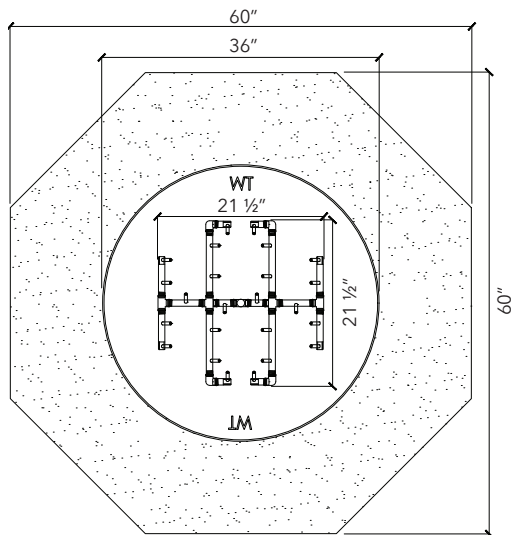

FO60NG | FO60LP

60" W x 18" H Aluminum Frame with Concrete Board Attached
CFB290 Original Brass Burner
36" Aluminum Pan with 2" Sidewalls
Fire Pit Vent Kit
¾" Dual Flex Line Kit
Key Valve Extension
Ignition systems available: Push Button, 24 Volt Spark Ignition, 24 Volt Hot Surface Ignition

SHIPS FREIGHT

CIRCULAR READY-TO-FINISH KITS

TECH TIP

Ready-to-Finish Kits come with a Fire Pit Vent Kit (FPVK) but they do not come pre-installed as placement and installation depends on veneer. Vents are to be installed by contractor on site.

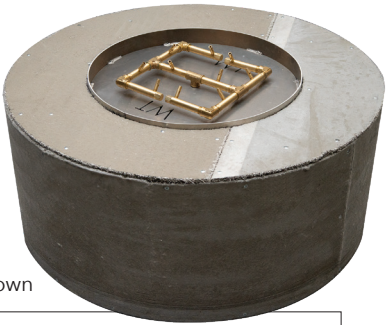

FC42 shown

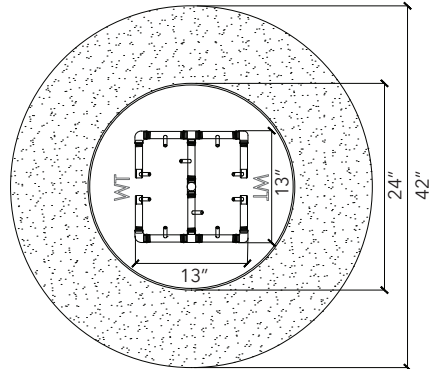

FC42NG | FC42LP

42" W x 18" H Aluminum Frame with Concrete Board Attached
CFB120 Original Brass Burner
24" Aluminum Pan with 2" Sidewalls
Fire Pit Vent Kit
¾" Flex Line Kit
Key Valve Extension
Ignition systems available: Push Button, 3 Volt, 24 Volt Spark Ignition, 24 Volt Hot Surface Ignition (SC)

SHIPS FREIGHT

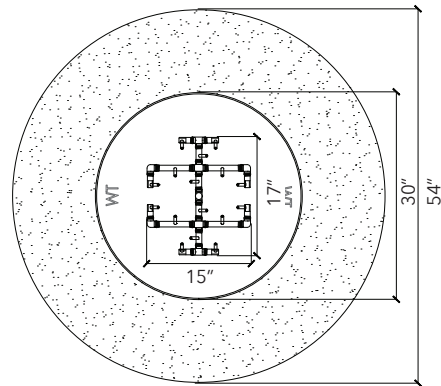

FC54NG | FC54LP

54" W x 18" H Aluminum Frame with Concrete Board Attached
CFB180 Original Brass Burner
30" Aluminum Pan with 2" Sidewalls
Fire Pit Vent Kit
¾" Flex Line Kit
Key Valve Extension
Ignition systems available: Push Button, 24 Volt Spark Ignition, 24 Volt Hot Surface Ignition (SC)

SHIPS FREIGHT

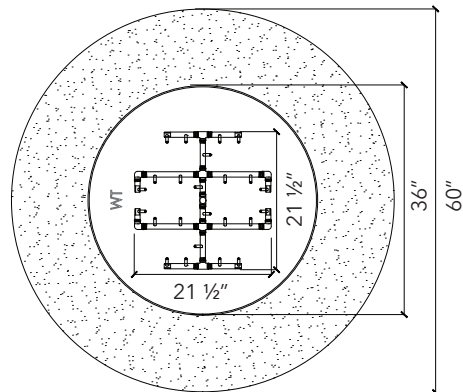

FC60NG | FC60LP

60" W x 18" H Aluminum Frame with Concrete Board Attached
CFB290 Original Brass Burner
36" Aluminum Pan with 2" Sidewalls
Fire Pit Vent Kit
¾" Dual Flex Line Kit
Key Valve Extension
Ignition systems available: Push Button, 24 Volt Spark Ignition, 24 Volt Hot Surface Ignition (SC)

SHIPS FREIGHT

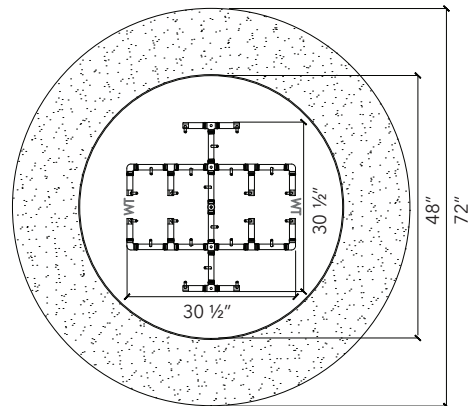

FC72NG | FC72LP

72" W x 18" H Aluminum Frame with Concrete Board Attached
CFB350 Original Brass Burner
48" Aluminum Pan with 2" Sidewalls
Fire Pit Vent Kit
¾" Dual Flex Line Kit
Key Valve Extension
Ignition systems available: 24 Volt Spark Ignition, 24 Volt Hot Surface Ignition (HC)

SHIPS FREIGHT

SQUARE READY-TO-FINISH KITS

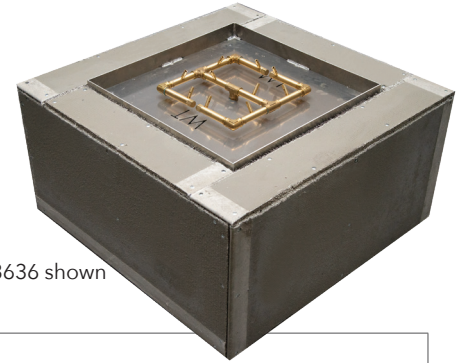

FS3636 shown

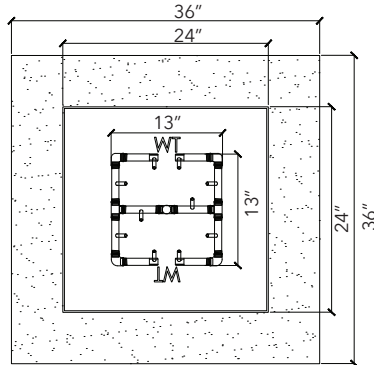

FS3636NG | FS3636LP

36" x 36" W x 18" H Aluminum Frame with Concrete Board Attached
CFB120 Original Brass Burner
24" Aluminum Pan with 2" Sidewalls
Fire Pit Vent Kit
¾" Flex Line Kit
Key Valve Extension
Ignition systems available: Push Button, 3 Volt, 24 Volt Spark Ignition, 24 Volt Hot Surface Ignition (SC)

SHIPS FREIGHT

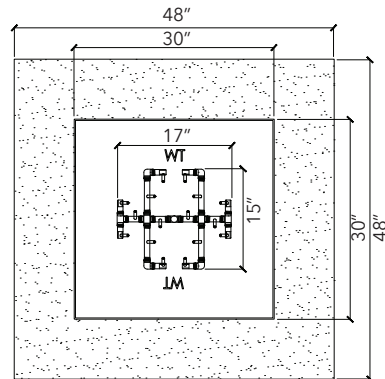

FS4848NG | FS4848LP

48" x 48" W x 18" H Aluminum Frame with Concrete Board Attached
CFB180 Original Brass Burner
30" Aluminum Pan with 2" Sidewalls
Fire Pit Vent Kit
¾" Flex Line Kit
Key Valve Extension
Ignition systems available: Push Button, 24 Volt Spark Ignition, 24 Volt Hot Surface Ignition (SC)

SHIPS FREIGHT

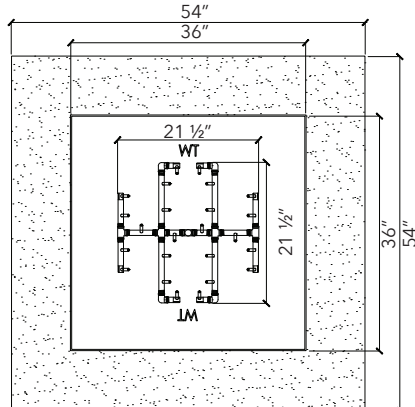

FS5454NG | FS5454LP

54" x 54" W x 18" H Aluminum Frame with Concrete Board Attached
CFB290 Original Brass Burner
36" Aluminum Pan with 2" Sidewalls
Fire Pit Vent Kit
¾" Dual Flex Line Kit
Key Valve Extension
Ignition systems available: Push Button, 24 Volt Spark Ignition, 24 Volt Hot Surface Ignition (SC)

SHIPS FREIGHT

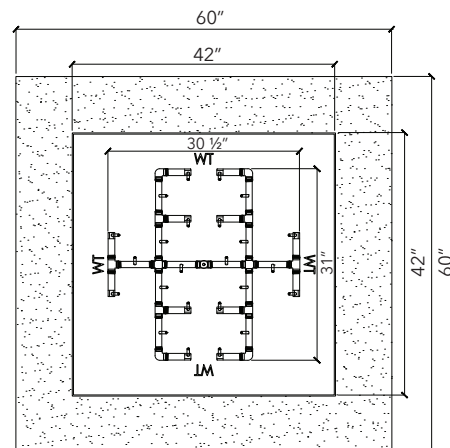

FS6060NG | FS6060LP

60" x 60" W x 18" H Aluminum Frame with Concrete Board Attached
CFB300 Original Brass Burner
42" Aluminum Pan with 2" Sidewalls
Fire Pit Vent Kit
¾" Dual Flex Line Kit
Key Valve Extension
Ignition systems available: 24 Volt Spark Ignition, 24 Volt Hot Surface Ignition (HC)

SHIPS FREIGHT



UNIVERSAL PAVER KITS

Universal Paver Kits are specifically designed to work with a variety of paver company block kits, including Techo-Bloc, Belgard, Pavestone, and many others.

Please confirm interior dimensions of your pit and choose the corresponding Universal Paver Kit for your project.

Questions? We're happy to help.
Call our Flame Consultants at
877 556 5255

UNIVERSAL PAVER KITS

Warming Trends® Universal Paver Kits include everything needed to complete or convert your paver fire pit.

Included in each kit:

- CROSSFIRE® Brass Burner
- Aluminum Plate
- Flex Line Kit
- Key Valve Extension
- Flexible Metal Support Collars

Select the Warming Trends Universal Paver Kit that matches the interior dimensions of your fire pit.

Questions? Want to customize your kit?
Give us a call at 877 556 5255

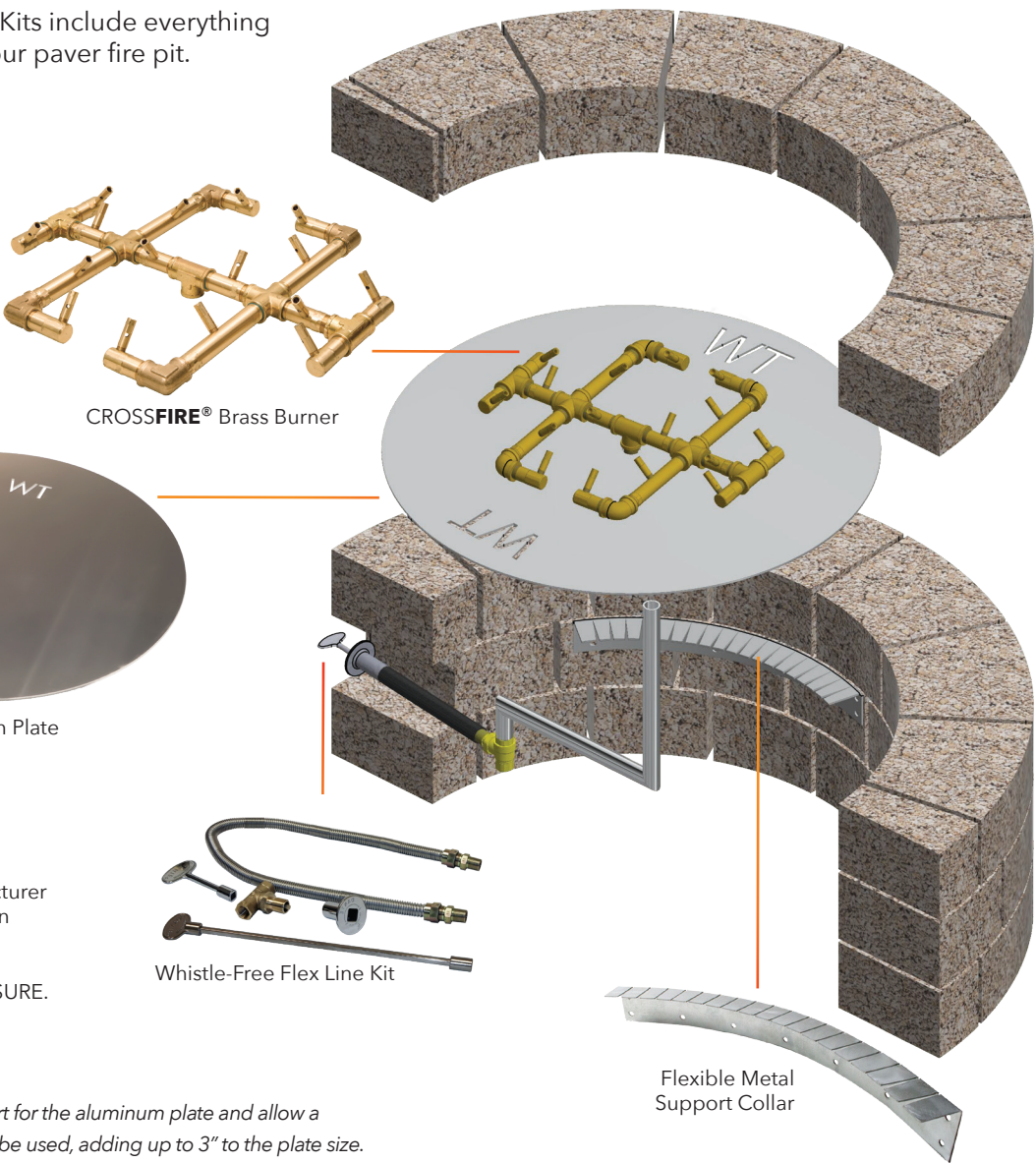

KIT DOES NOT INCLUDE VENTS. (Manufacturer recommends 18 sq. inches of ventilation on opposing sides of the fire feature.)

KIT DOES NOT INCLUDE STONE/ ENCLOSURE.

TECH TIP Collars provide support for the aluminum plate and allow a range of plate sizes to be used, adding up to 3" to the plate size.



FLEXIBLE METAL SUPPORT COLLAR

COLLAR	19" Flexible Metal Support Collar	19" x 15" x 5"
--------	-----------------------------------	----------------

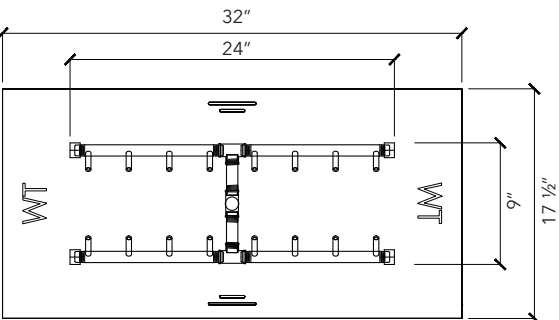

17 1/2" x 32" to 20 1/2" x 35" RECTANGULAR OPENING

UPK160H3217NG UPK160H3217LP	
CFBH160 H-Style Brass Burner 17 1/2" x 32" Rectangular Aluminum Plate 3/4" Flex Line Kit Key Valve, Key Valve Extension, Key (5) Collars	34 lbs 36" x 23" x 12"

UNIVERSAL PAVER KITS

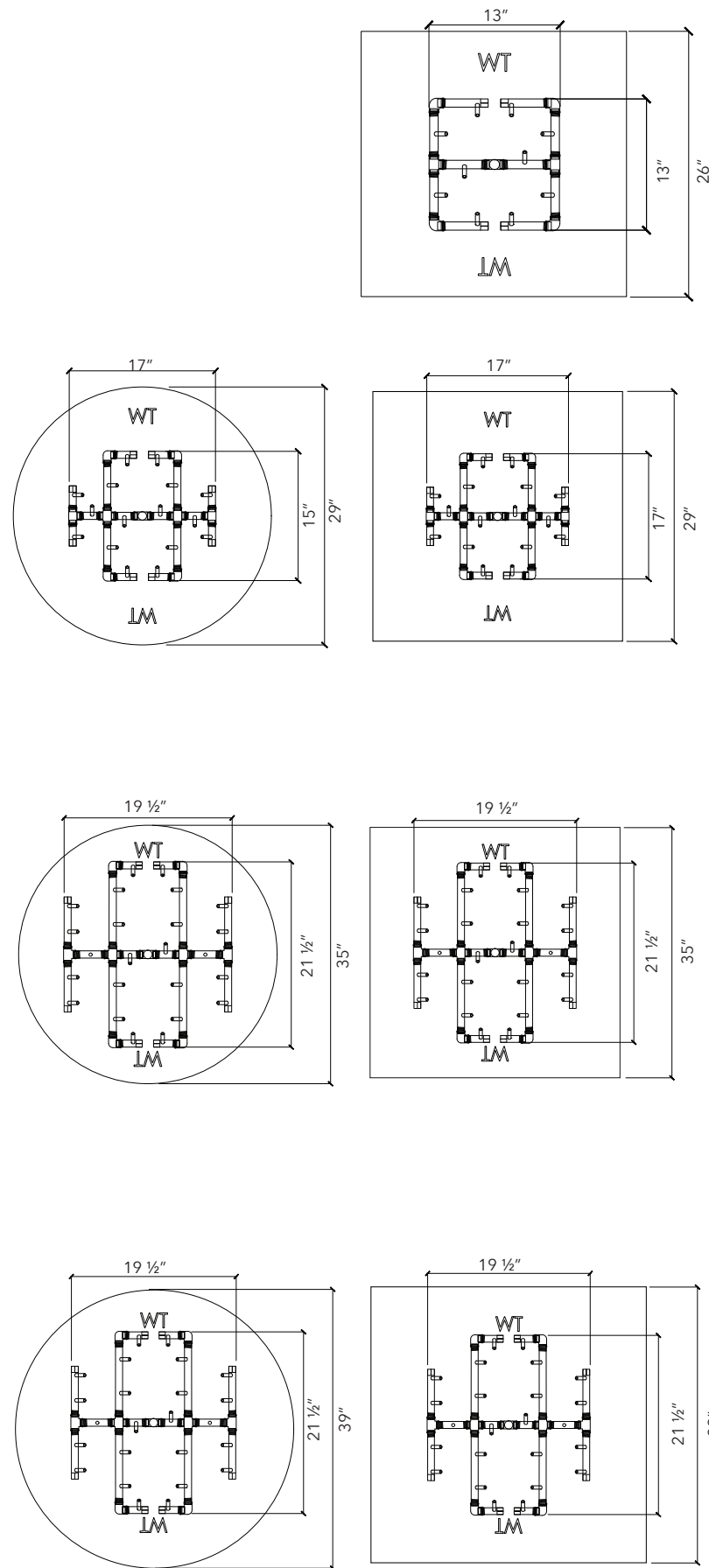

26" - 28" OPENING

UPK120S26NG UPK120S26LP	
CFB120 Original Brass Burner, 26" Square Aluminum Plate, 3/4" Flex Line Kit, Key Valve Extension, (4) Collars	22 lbs 29" x 29" x 7"

29" - 31" OPENING

UPK180C29NG UPK180C29LP	
CFB180 Original Brass Burner, 29" Circular Aluminum Plate, 3/4" Flex Line Kit, Key Valve Extension, (5) Collars	28 lbs 31" x 31" x 7"

UPK180S29NG UPK180S29LP	
CFB180 Original Brass Burner, 29" Square Aluminum Plate, 3/4" Flex Line Kit, Key Valve Extension, (5) Collars	30 lbs 33" x 33" x 7"

35" - 37" OPENING

UPK240C35NG UPK240C35LP	
CFB240 Original Brass Burner, 35" Circular Aluminum Plate, 3/4" Flex Line Kit, Key Valve Extension, (6) Collars	41 lbs 37" x 37" x 7"

UPK240S35NG UPK240S35LP	
CFB240 Original Brass Burner, 35" Square Aluminum Plate, 3/4" Flex Line Kit, Key Valve Extension, (6) Collars	47 lbs 39" x 39" x 7"

39" - 41" OPENING

UPK240C39NG UPK240C39LP	
CFB240 Original Brass Burner, 39" Circular Aluminum Plate, 3/4" Flex Line Kit, Key Valve Extension, (7) Collars	SHIPS FREIGHT

UPK240S39NG UPK240S39LP	
CFB240 Original Brass Burner, 39" Square Aluminum Plate, 3/4" Flex Line Kit, Key Valve Extension, (7) Collars	SHIPS FREIGHT

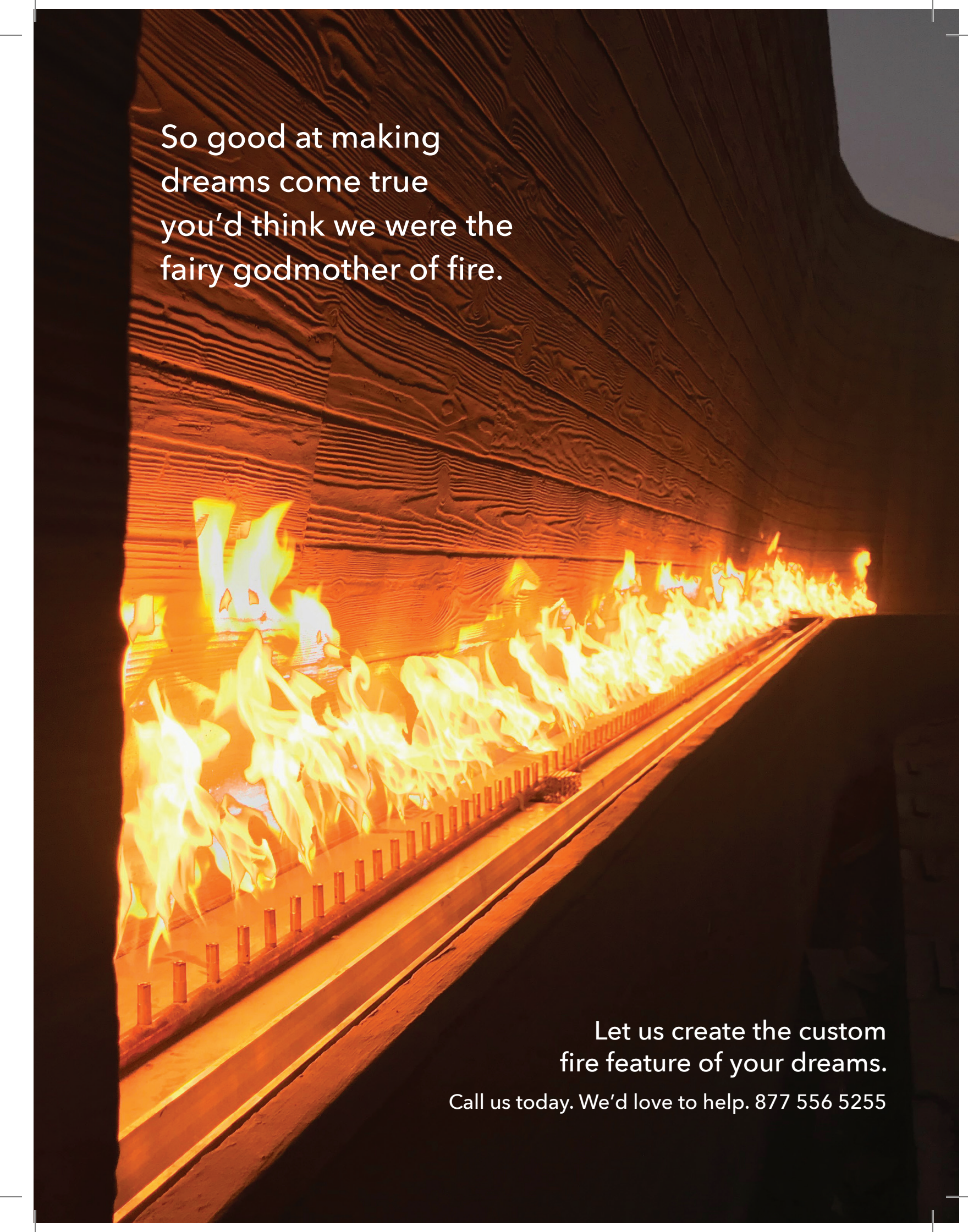

So good at making
dreams come true
you'd think we were the
fairy godmother of fire.

Let us create the custom
fire feature of your dreams.

Call us today. We'd love to help. 877 556 5255



IGNITIONS, ACCESSORIES, AND MEDIA

Select the right accents to complement your feature's surroundings. Complete with a secure cover made to fit.

IGNITION SYSTEMS



MATCH LIT

All CROSSFIRE® Brass Burners come standard as a manual Match Lit System. Light a match and turn the key valve to ignite your fire feature burner.



PUSH BUTTON IGNITION

Upgrade to an electric Push Button Ignition. Turn the key valve to on position and push the button to ignite your burner.

SKU	DESCRIPTION
PBIK3.0	Push Button Ignition Kit: Spark Igniter Rod and Wire + Push Button Battery Operated Control Module
PBIK3.0MBRKV12	Push Button Ignition Kit + Mounting Bracket + 1/2" Key Valve + (2) Pre-mounted 1/2" Street Elbows
PBIK3.0MBRKV34	Push Button Ignition Kit + Mounting Bracket + 3/4" Key Valve + (2) Pre-mounted 3/4" Street Elbows
PBIK3.0MBRFK1	Push Button Ignition Kit + Mounting Bracket + 3/4" Flex Line Kit + (2) Pre-mounted 3/4" Street Elbows
PBIK3.0MBRFK2	Push Button Ignition Kit + Mounting Bracket + 3/4" Dual Flex Line Kit + (2) Pre-mounted 3/4" Street Elbows
Replacement Parts	
PB-SI	Spark Igniter Rod and Wire
PB-CM	Push Button Battery Operated Control Module
MBR	Mounting Bracket with (2) Pre-mounted 3/4" Street Elbows

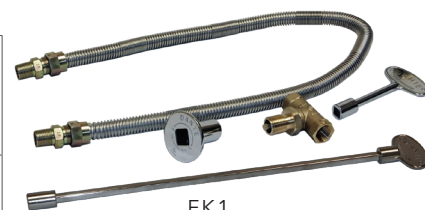

FK1

3/4" Flex Line Kit included in the PBIK3.0MBRKV1

For use with any burner 249K BTUs and below.



FK2

3/4" Dual Flex Line Kit included in the PBIK3.0MBRFK2

For use with any burner 250K BTUs and above.



3 VOLT IGNITION

A battery-operated ignition system with on and off switch. 3 Volt Ignition supplies up to 120K BTUs. Remote control available.

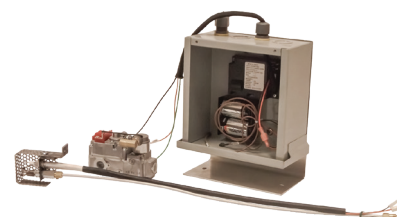

3VIK-NG 3VIK-LP	3 Volt Electronic Ignition System: Spark Igniter + Control Module + D-Cell Battery Pack + 3 Volt Gas Valve + up to 120K BTU + Ignition Switch
--------------------	---



24 VOLT SPARK IGNITION

24 Volt Spark Ignition supplies up to 400K BTUs. Includes step down transformer for use with 24 Volt/110 Volt supply. Remote control options available.

24VIKHC-NG 24VIKHC-LP	24 Volt Spark Ignition System: Spark Igniter + Control Module + 24 Volt Transformer + up to 400K BTU
--------------------------	--

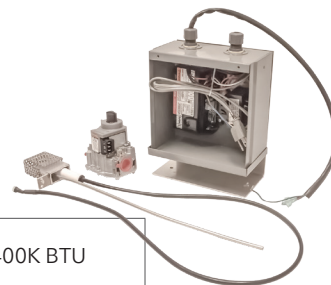

24 VOLT HOT SURFACE IGNITION

24 Volt Hot Surface Ignition Standard Capacity supplies up to 290K BTUs.
24 Volt Hot Surface Ignition High Capacity supplies up to 512K BTUs.
Includes step down transformer for use with 24 Volt/110 Volt supply.
Remote control options available.

P24VIKSCCG-NG P24VIKSCCG-LP	24 Volt Hot Surface Ignition System - Standard Capacity: Hot Surface Igniter + 50VA/24VAC Transformer + Maximum Gas Output 290K BTU/hr
P24VIKHCCG-NG P24VIKHCCG-LP	24 Volt Hot Surface Ignition System - High Capacity: Hot Surface Igniter + 50VA/24VAC Transformer + Maximum Gas Output 512K BTU/hr

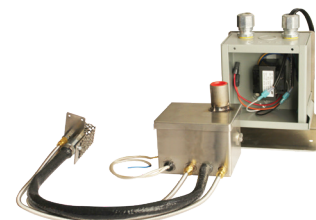

Low voltage Premium Ignition available. Call a Warming Trends® Flame Consultant to discuss the best ignition system for your CROSSFIRE® Brass Burner.

TECH TIP

Aluminum covers help protect electronic ignition systems from the elements.
Available in standard and custom sizes. Custom and standard sizes available, page 46.

ELECTRONIC ADD-ONS



3 VOLT REMOTE

3VRC	ON/OFF Remote Control for 3 Volt Ignition System
------	--



24 VOLT KEY CHAIN REMOTE

KCRC	ON/OFF Wireless Key Chain Remote Control & Plug In Receiver for 24 Volt Ignition System
------	---



EMERGENCY STOP

EMERSTOP	Push Button Emergency Stop with yellow shell and weatherproof lift cover. Recommended for commercial properties.
----------	--



DIAL TIMERS

Available in 2 hour and 12 hour options for automatic shut off, with or without NEMA Rated outdoor enclosure.

DT2HR	2 Hour Dial Timer
DT2HRNB	2 Hour Dial Timer with NEMA Rated Enclosure
DT12HR	12 Hour Dial Timer
DT12HRNB	12 Hour Dial Timer with NEMA Rated Enclosure

TECH TIP

Typically commercial projects require an Emergency Stop and electronic ignition. Consult your local code.

MEDIA

TECH TIP

Easily calculate how much lava rock or fire glass will be needed with the Fire Glass calculator on our website.

LAVA ROCK



BLR

1" - 1 1/2" Black Lava Rock, 1 bag per 1 cubic foot 45 lbs



LRR

1" - 2" Gray/Black Rolled Lava, 1 bag per 1 cubic foot 50 lbs

FIRE GLASS 3/4" Fire Glass. Colors may vary from photo.

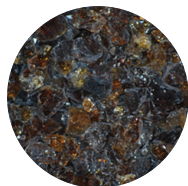

CS AMBER 9
Dark Amber



CS AMBER 4
Light Amber



BURNT ORANGE
Burnt Orange



CA RED
Red

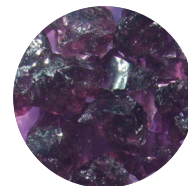

MN PURPLE 4
Purple

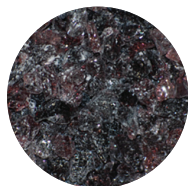

PLUM 7
Plum

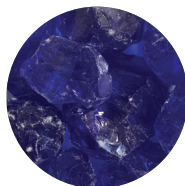

CO BLUE 5
Dark Blue

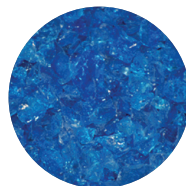

CO BLUE 3
Light Blue

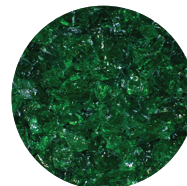

CR GREEN 6
Dark Green



CR GREEN 4
Light Green

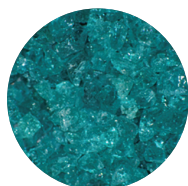

AQUA 2
Aqua

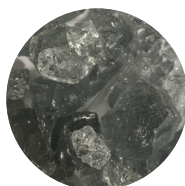

GRAY 5
Gray

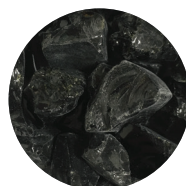

BLACK
Black



CLEAR
Clear



Additional Options Available Upon Request

CERAMIC LOG SETS



WESTERN OAK LOG SETS

Additional sizes available upon request.

WOS	Western Oak Log Set for 24" - 30" Fire Pit (8 Pieces)
WOM	Western Oak Log Set for 36" - 42" Fire Pit (12 Pieces)
WOL	Western Oak Log Set for 48" Fire Pit (15 Pieces)



MOUNTAIN SPLIT LOG SETS

Additional sizes available upon request.

MSS	Mountain Split Log Set for 24" - 30" Fire Pit (8 Pieces)
MSM	Mountain Split Log Set for 36" - 42" Fire Pit (12 Pieces)
MSL	Mountain Split Log Set for 48" Fire Pit (15 Pieces)



STEEL LOG SETS

Available for 18", 24", 30", and 36" Fire Pits.

SKU	DESCRIPTION	SHIP WEIGHT + DIMS
SLS18	Handcrafted to fit 18" Fire Pit	SHIPS FREIGHT
SLS24	Handcrafted to fit 24" Fire Pit	SHIPS FREIGHT
SLS30	Handcrafted to fit 30" Fire Pit	SHIPS FREIGHT
SLS36	Handcrafted to fit 36" Fire Pit	SHIPS FREIGHT
SLSCUST	Custom Handcrafted Steel Log Set	SHIPS FREIGHT



FIRESTORM® STEEL LOG

Handcrafted, one-of-a-kind steel gas log with integrated burner

SKU	DESCRIPTION	SHIP WEIGHT + DIMS
FSL32LP	32" Steel log with integrated CFBL150 CROSSFIRE® Brass Burner on a 38" x 10" aluminum plate for Liquid Propane	SHIPS FREIGHT
FSL32NG	32" Steel log with integrated CFBL150 CROSSFIRE® Brass Burner on a 38" x 10" aluminum plate for Natural Gas	SHIPS FREIGHT

TECH TIP Custom Steel Log Sets and FireStorms are available. Give us a call at 877 556 5255

COVERS

Aluminum covers are available in standard fire pit sizes. More standard and custom sizes available.

CIRCULAR



SKU	DESCRIPTION	SHIP WEIGHT + DIMS	
FPC26C	26" Circular + 1 handle. For 24" opening.	13 lbs	27" x 27" x 7"
FPC32C	32" Circular + 1 handle. For 30" opening.	19 lbs	33" x 33" x 9"
FPC38C	38" Circular + 2 handles. For 36" opening.	23 lbs	39" x 39" x 7"
ALPLCUST	Covers customized to any shape or size	Call for Quote	

SQUARE

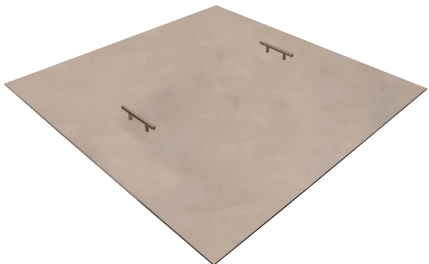

SKU	DESCRIPTION	SHIP WEIGHT + DIMS	
FPC26S	26" Square + 1 handle. For 24" opening.	16 lbs	29" x 29" x 7"
FPC32S	32" Square + 1 handle. For 30" opening.	23 lbs	37" x 37" x 9"
FPC38S	38" Square + 2 handles. For 36" opening.	SHIPS FREIGHT	
ALPLCUST	Covers customized to any shape or size	Call for Quote	

WARRANTY

FULL LIFETIME WARRANTY FOR WARMING TRENDS® BURNERS

WARMING TRENDS warrants that each WARMING TRENDS® Crossfire® and other jetted-flame-brass-burners (each as "Burner") is free from defects in materials and workmanship and conforms to its specifications, which are available upon request.

The warranty period for a Burner is lifetime warranty beginning on the date of purchase ("Warranty Period"). This Warranty is transferable, but we reserve the right to require proof of ownership for any transferred burners including proof that the Burner was not acquired through improper means or unauthorized re-sellers. During the Warranty Period, WARMING TRENDS provides repair and exchange services for the Burners, without charge. If a Burner does not function as warranted during the Warranty Period and, after a reasonable number of attempts, WARMING TRENDS is unable to either 1) make it do so or 2) replace it with one that is at least functionally equivalent, you may return it to WARMING TRENDS and your money will be refunded.

The warranty stated above will not apply to the extent that there has been misuse or use contrary to specifications or the appropriate user or operating manual, installation defect, accident, modification, unsuitable physical or operating environment, operation in other than the specified operating environment (e.g., outdoor burners should only be used outdoors) improper maintenance by you, or failure caused by a product for which WARMING TRENDS is not responsible. With respect to Burners, the warranty is voided by removal or alteration of any identification labels or marks on any Burner or part.

THESE WARRANTIES ARE YOUR EXCLUSIVE WARRANTIES AND REPLACE ALL OTHER WARRANTIES OR CONDITIONS, EXPRESS OR IMPLIED, INCLUDING, BUT NOT LIMITED TO, THE IMPLIED WARRANTIES OR CONDITIONS OF MERCHANTABILITY AND FITNESS FOR A PARTICULAR PURPOSE.

ITEMS NOT COVERED BY WARRANTY

Other than as expressly stated above, WARMING TRENDS does not warrant uninterrupted or error-free operation of any Burner or that WARMING TRENDS will correct all defects.

Warming Trends does not warranty any services related to our Burners, including installation, unless we provided those services to you. You may have warranty rights from the service provider, but we make no representations or warranties express or implied regarding any third party service provider.

This warranty also does not apply to any fire logs (including the FireStorm® Steel Log) or any of the electronics used in connection with our Burners, which may be covered by separate warranties with different terms.

YOUR RIGHTS UNDER STATE LAW

This Warranty gives you specific legal rights, and you may also have other rights which vary from state to state. You may find this information from the Federal Trade Commission helpful in understanding your rights, but we recommend you speak to your attorney regarding your specific situation and the laws in your state or jurisdiction. <https://www.consumer.ftc.gov/articles/0252-warranties>

IGNITION SYSTEMS WARRANTY ALL BURNERS AND ELECTRONICS MUST BE COVERED WHEN NOT IN USE OR WARRANTY IS NULL AND VOID

Push Button Ignition Systems: There is no warranty offered on any push button ignition system.

Electronic Ignition Systems

RESIDENTIAL INSTALLATIONS:

24VIK and 3VIK systems are fully warranted for one (1) year with a limited warranty for two (2) years from date of purchase. In the event a system must be replaced due to a defect/malfunction of the system, Warming Trends will repair or replace the system at no cost for the first year. In the event a system fails after the first year from date of purchase and within two years from date of purchase, Warming Trends will repair or replace the system for a cost of 50% of the current list price. This warranty does not cover labor costs.

P24VIK systems purchased ON OR BEFORE April 15, 2018 are fully warranted for one (1) year with a limited warranty for two (2) years from date of purchase. In the event a system must be replaced due to a defect/malfunction of the system, Warming Trends will repair or replace the system at no cost for the first year. In the event a system fails after the first year and within two years of date of purchase, the cost for a replacement system is at a discount rate of 50% of the current listed price. This warranty does not cover labor costs.

P24VIK Systems purchased AFTER April 15, 2018 are fully warranted for three (3) years from date of purchase. In the event a system must be replaced due to a defect/malfunction of the system, Warming Trends will repair or replace the system at no cost for the first three years. This warranty does not cover labor costs.

COMMERCIAL INSTALLATIONS:

24VIK and 3VIK systems are fully warranted for twelve months from date of purchase. In the event a system must be replaced due to a defect/malfunction of the system, Warming Trends will repair or replace the system at no cost. This warranty does not cover labor costs.

P24VIK Systems are fully warranted for one (1) year from date of purchase. In the event a system must be replaced due to a defect/malfunction of the system, Warming Trends will repair or replace the system at no cost for 12 months from the date of purchase. This warranty does not cover labor costs.

Problems in the functioning of the systems due to gas plumbing or electrical installed by others are not covered by any warranty offered by Warming Trends.

No dealer, distributor, or other person has the authority to represent or warrant a Warming Trends product beyond the terms contained within this warranty, and Warming Trends assumes no liability for such warranty representations. Any questions concerning this warranty should be directed to the Warming Trends corporate office.

RETURN POLICY OF WARRANTY PRODUCT

Any Warming Trends product deemed by Warming Trends as defective and covered by the warranty may be returned to Warming Trends for assessment to determine if repair or replacement is necessary. In order to return a product, you must have a Return Merchandise Authorization number (RMA#). Please contact Warming Trends at orders@warming-trends.com or 877-556-5255 to obtain an RMA#. All returned merchandise must have the RMA# clearly printed on the outside of the package. Return shipping costs are the purchaser's responsibility. Warming Trends is not responsible for product damaged or lost in transit. It is recommended that return items are shipped via a delivery service that can be tracked and/or insured to confirm receipt.

Don't settle for less.



Standard Ring Burner with 180K BTU's



CFB180 CROSSFIRE® Brass Burner with 180k BTU's



Twice the
Flame



Patented All Brass
Construction



Lifetime
Warranty



Made in
the US

WARMING TRENDS®

www.Warming-Trends.com | 303 346 2224

Proud Members of

